

# Year 7 Parent & Pupil Information Booklet 2022



**WHICKHAM  
SCHOOL**

# Contents

<b>Introduction from Mr F Turnbull</b>	<b>3</b>
<b>Whickham School Qualities</b>	<b>4</b>
<b>About Whickham School</b>	<b>5</b>
<b>Whickham School 2020-21 Curriculum Summary</b>	<b>6</b>
<b>Curriculum</b>	<b>7</b>
<b>Uniform</b>	<b>16</b>
<b>Cashless Catering: Biometric</b>	<b>18</b>
<b>Free School Meals - Are You Entitled?</b>	<b>18</b>
<b>ParentPay</b>	<b>19</b>
<b>Attendance Matters</b>	<b>20</b>
<b>Scholars Transport Timetables</b>	<b>25</b>
<b>Behaviour Expectation</b>	<b>27</b>
<b>Safeguarding</b>	<b>28</b>
<b>The Achievement Team</b>	<b>29</b>
<b>Tutor Time Activities</b>	<b>30</b>
<b>Whickham Equipment / Starter Packs</b>	<b>31</b>
<b>P.E. Guidelines</b>	<b>32</b>
<b>P.E. Kit Information</b>	<b>32</b>
<b>Class Charts</b>	<b>33</b>
<b>Term Dates</b>	<b>34</b>
<b>School Site Map</b>	<b>35</b>



**Dear Parent/Carer,**

It gives me great pleasure to welcome you and your family to Whickham School.

We are a school that cares about everyone in our community and aims to ensure that every Whickham student develops into a well-rounded citizen who is able to make the most of their unique talents and abilities.

Studying at Whickham is an enjoyable and rewarding experience. Our curriculum enables all students to develop a breadth of knowledge and range of skills that prepares them well for life and their future careers. Academic achievement is important and we are proud of the success our students achieve, but being a Whickham student is about much more than this. Whickham students access a range of exciting experiences that support personal development and are supported in developing the personal qualities that enable them to be people we are proud to know.

We believe that strong and positive relationships with parents and carers are critical in ensuring a partnership is built that supports the success of each student. This booklet outlines important information about our school and the expectations we have of each student.

I look forward to meeting you and your child.

Yours faithfully,

**Mr F Turnbull**  
**Headteacher**





# Whickham School Qualities

## Mission Statement

**Whickham School; a school that ensures all students can be the best that they can be.**

In achieving this aim we ensure all students develop into well rounded citizens who possess the skills, knowledge and qualifications that will enable them realise their full potential. Our curriculum and student support services focus upon developing the following qualities:

**Aspiration** - Whickham students set aspirational goals that are ambitious and without limitations.

**Respect** - Without compromise, Whickham students demonstrate respect for themselves, others and their environment.

**Resilience** - Whickham students persevere with challenges, especially when faced with setbacks.

**Empathy** - Whickham students strive to be kind, caring and understanding of each other's feelings and needs.



# About Whickham School

## The School

Whickham School is a large and successful school in Gateshead. We are oversubscribed with over 1700 pupils including over 400 in the Sixth Form. Standards are high and in the 2019 GCSE exams, 79% of pupils achieved a 4+ in English and 78% achieved 4+ in Maths.

Our Sixth Form is very successful with 50% of pupils attaining a A\*-B grade in the 2019 A Level exams. Our average Value Added score over the last 3 years was +0.27 meaning that students on average gain over a quarter of a grade better in each of their A Level qualifications than in a national average Sixth Form. Our vocational performance is ever stronger with an average Value Added score of +0.56 meaning that performance is over half a grade better in each subject.

## Ofsted

Our March 2018 Ofsted inspection reflects that we are a good school who 'recognise the importance of examination results as well as the development of pupils' characters.'

***'Relationships between staff and pupils are positive and founded on mutual respect.'***

***'The Headteacher leads by example. He is uncompromising in his desire for all pupils to succeed.'***

***'Pupils' spiritual, moral, social and cultural awareness is developed very effectively.'***

***'When asked by an inspector to describe the best thing about coming to this school, one pupil responded by saying that 'you can be who you want to be and you do not get judged by others.'***

## School Organisation

The School has been an academy since 2011. The headteacher oversees the daily running of the school supported by a leadership team who meet weekly. Curriculum subjects are overseen by eight faculty leaders who have responsibility for ensuring that the curriculum supports all pupils to make progress. Pastorally each year group is overseen by a Pastoral Leader and pupils will be placed into one of nine pastoral tutor groups in each year group. As far as possible pupils will keep the same tutor each year to help build relationships and ensure pupils feel well supported in school.

## The Governing Body

The governing body is enthusiastic and active and they bring a wide range of experiences and skills derived from their diverse employment in commerce, industry and education.

The relationship between the senior leadership team and the governing body has evolved into one which enables open and frank discussion to take place on school issues. The introduction of more link governors to specific school subject areas has improved governor involvement and awareness of issues and priorities. Strengths and weaknesses are discussed freely.

The relationship between the governing body and staff is one of mutual trust and openness. The governing body endeavours to provide support as well as challenge and to become actively involved in all school matters. We consider the governing body to be part of the school leadership team and they support the school in its quest to maximise the achievement of all pupils, in a happy, interesting, and safe environment.

# Whickham School 2022-23

## Curriculum Summary

At Whickham School, we aim to provide a broad and engaging curriculum that enables pupils to fulfil their talents and interests, whilst gaining the knowledge and skills needed to succeed in their further studies, training and employment. High quality information and guidance is provided to help pupils navigate their pathways through the courses on offer.

A strong foundation is provided at Key Stage 3 where pupils follow a broad and balanced curriculum comprising the following subjects: Science, Mathematics, English, Modern Languages, Geography, History, RE, Technology, ICT, Art and Design, Music, Religious Studies and Citizenship.

Pupils are allocated to mixed ability tutor groups. Much of the teaching in Key Stage 3 takes place in mixed ability groups although we set by ability in Mathematics (from Y7) and, (from Y9), English.

During Year 9 pupils will be supported in choosing their optional subjects for Key Stage 4. In Years 10 and 11 pupils follow a two-year programme of GCSE and Vocational subjects. Pupils choose from a wide variety of different courses across many different subject areas.

In addition to the core academic subjects that pupils study, and the opportunity to complete the "English Baccalaureate", we have an extensive range of highly successful creative and vocational courses that enable us to engage all pupils in making strong progress.

The school has a strong SEND (Special Educational Needs & Disabilities) department that provides additional support to encourage academic progress at all key stages.

The breadth of choice continues into the Sixth Form, with large numbers of pupils selecting from over 35 different A Level and vocational courses.

Whickham School is alive with activities that offer pupils the opportunity to broaden their interests and experience:

- Physical Education is highly prominent with a wide range of interests catered for. Our sports leadership programme is particularly strong
- The Performing Arts are also considerable strengths in the school. The school puts on a number of productions each year including an annual musical which plays to packed audiences for a week. The school band and drama groups perform at various prestigious events.
- Educational visits and exchanges are organised for pupils of all ages.





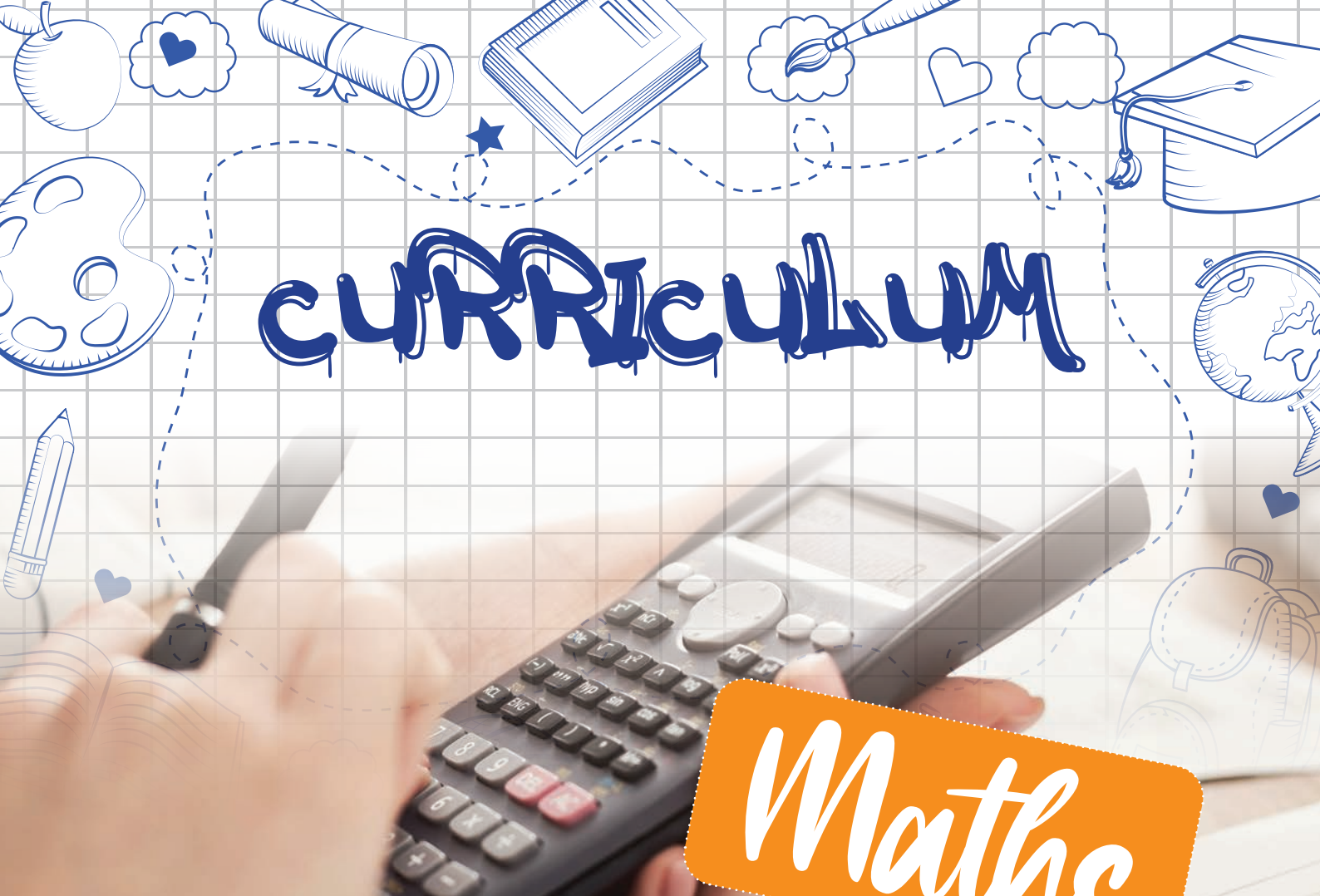

# CURRICULUM

## Maths

We hope you are looking forward to starting your first year at Whickham School. In the Maths department our aim is to further develop you as masters of mathematics!

We will build on all of the skills you have acquired in Primary School through problem solving and reasoning activities. We like to include lots of variety in lessons, with various types of tasks and lots of group work.

We are really interested in making sure you understand why you're doing what you're doing in our maths lessons. We aim to build confidence and challenge you to think deeper and make connections between topics.

You will have eight lessons of Maths per fortnight and in Year 7 the main topics covered are place value, directed numbers, fractions and algebra.

Once a fortnight, you will have a 'Problem of the Fortnight' lesson, where you will work on a longer problem for the whole lesson and be expected to hone in on those problem-solving and reasoning skills in your answers and findings, working independently or in small groups. These lessons are very popular with our current students, and we are confident you will enjoy them just as much.

All we require from you is to try your best - be resilient, independent and responsible. In a nutshell; 'be the BEST you can be', and we promise to provide fun lessons, homework and support all to allow you to do this! See you in September :)

### EXTRA OPPORTUNITIES

- Three days a week, we have a Maths homework club that runs as a drop-in supported by staff in the department. Come here for help with your homework.
- Look out for the weekly problem on the projector in the atrium!
- Make sure to have a go at the problem of the fortnight that you have been sent as part of your transition activities – this will show you how a 'POF' lesson works and all of the key skills you will need to answer that question!

# ENGLISH

Year 7 begins with *Me, Myself and I: Autobiography*, an exciting unit where you will reflect on your own journey so far, giving thanks for your family, friends and experiences, hearing from others about their own journeys and transforming this into writing.

This develops into our first novel at Whickham School, *Coraline* by Neil Gaiman. This is a challenging, wonderfully written and imaginative fantasy tale. Reading out loud is absolutely encouraged in our classrooms! You're then off on a journey around the world in our travel-inspired Descriptive Writing module! During this module, you will develop your ability to write with imagination by mimicking the style of other writers you will have studied – there are lots of opportunities to get creative with language in this module!

The next unit of the year is *Literary Legends*. We study prose and poetry of Charles Dickens, William Blake and Elizabeth Barrett Browning and get all theatrical in our study of Shakespeare, learning about the playwright's craft. Then finally, you will finish the year experiencing a range of poems inspired by many different cultures. In this module, you will become acquainted with the ways in which poets celebrate culture and diversity through language – you even get the chance to write your own poem!

One hour per fortnight is dedicated to Accelerated Reading in the library and this is encouraged at home too. We get a bit competitive here, with classes competing to see who can read the most, and a pizza party for the winning class each term.

## EXTRA OPPORTUNITIES

Throughout the year, there will be many opportunities to get involved in extracurricular reading activities. For example, World Book Day sees a fancy-dress competition, literary book hunt and class activities. You can also see other options as part of the Drama schedule which will help to support your English passions and talents.



In P.E. we will be building on the fundamental skills that you have developed at Primary school. During Year 7 this will be delivered through a range of activities such as football, netball, rugby, basketball, gymnastics, dance, athletics and cricket.

Within each of these activities we will look to develop your physical ability so that you have the necessary skills to perform with confidence and enjoyment.

Your aim should be to develop six different multi abilities to ensure success in PE:

- **Physical** - Acquire and develop performance skills.
- **Cognitive** - Select and apply skills, tactics in a range of sports.
- **Creative** - Select and apply compositional ideas in dance and gymnastics.
- **Social** - Evaluate and improve performance (self and peer assessment).
- **Health and Fitness** - Develop knowledge and understanding of fitness and health.
- **Personal** - Demonstrate a desire to improve.

Hopefully, this will inspire you to attend the various extra-curricular P.E. clubs on offer, inspiring you to value physical activity and the contribution it makes towards leading a healthy, active lifestyle.

## EXTRA OPPORTUNITIES

- In P.E. we offer a range of activities for those seeking competitive fixtures against other schools and for those looking to play recreational sport for enjoyment.
- Most of our curriculum-based sports have a school team that you could represent.
- In Year 7 you will also be given the opportunity to represent your tutor group in an inter-house competition. This will run during lunchtimes and offers competitions across a range of sports.
- We also run an 'Active lunch' recreational programme, where you can play sport with your friends during your lunch break.



# Art

We hope you are looking forward to having specialist art lessons at Whickham. We have a whole floor of amazing specialist art rooms right at the top of the new school building and we think you will really enjoy the calm, creative atmosphere we have there. Don't worry if you aren't confident about your art skills! Your art teachers are brilliant at showing you how to improve your artmaking, but we do expect you to try your best and not be put off if you don't get it the first time. We will be working on a number of projects across the year, all designed to help you improve your skills and understanding of art.

- We will study the work of different artists to inform our ideas.
- You will get the opportunity to use a whole range of materials including pencil, paint, clay and fabrics (Textiles) and mixed media
- You will be given regular feedback in your sketchbooks to help you improve the Developing, Refining, Recording and Presenting of your ideas.
- You will be given homework which could include research, drawing or responding to feedback.

You will need your equipment pack and your sketchbook in every lesson. (Both can be ordered from the school).

You only need to take your sketchbook home when you have homework to complete.

## EXTRA OPPORTUNITIES

- There will be an Art club that takes place after school one night during the week, time TBA. We will create Christmas Arts and Crafts, African Drums and posters exploring themes such as Cultural Diversity and Equality, Anti Bullying and Knife Crime to name but a few.
- But, if you are struggling with your homework, or just want to do something creative during lunchtimes, as a release from the pressure of the school day, you are more than welcome to work in art rooms with your teacher at lunchtimes or use the after school art club to help you.

# Drama

In Year 7 Drama you will start with introductory skills as students will arrive from KS2 with varying levels of dramatic experience. You will participate in fun group activities to support confidence building with your peers and on stage. You will be working towards being able to completing the following skills:

- **Group work**  
Contribution, Directing, Supportive, teamwork.
- **Techniques & Conventions**  
Skills linked to different styles of Drama for impact on the audience.
- **Voice**  
Projecting appropriate voices for a character.

- **Movement**  
Using body language to express a character.
- **Character**  
Creating roles that are consistent and engaging.
- **Analysis & Evaluation**  
Discuss how drama is constructed and judge its effectiveness.

Drama will encourage you to use your artistic creativity and will involve the creation of imagined characters and situations which you will enact within a safe space. You will recreate situations using other perspectives to reach new and exciting conclusions.

## EXTRA OPPORTUNITIES

There is a wealth of extra-curricular activities happening each week in the Drama Department for you to get involved with. We have annual whole school productions which have previously included: *Little Shop of Horrors*, *The Wizard of Oz*, *Oliver*, *Beauty and the Beast*, *Looserville* and *Grease*. A Drama club runs once a week which is currently open to all Key Stage 3 students on a Friday.





# Music

In music you will learn all you need to know to become a fully fledged musician. This will include learning about music notation (the language of music) how to compose (create music) and how to play various instruments such as the keyboard, guitars and drum kit.

## EXTRA OPPORTUNITIES

There are instrumental lessons that are available to pupils at Whickham School and information about how they work will be sent home to you in due course. As the year progresses there will be opportunities for you to join in with. This will include the school wind band, rock band, vocal groups and more. Keep an eye on the bulletin when you join the school for all the information you need!

# History

Throughout KS3, you will build the skills and knowledge to deepen your understanding of this amazing subject. History at Whickham broadly follows a chronological approach. From the Anglo-Saxons through to the upheavals of the 20th Century, you will study many fascinating periods and events. History in Year 7 will begin by looking at the question, 'How dark were the dark ages?' We will explore the period following the collapse of Roman control through to the arrival of the Normans in 1066. From here we will look at how the Normans gained control of England, and go on to examine how various groups in society experienced the Medieval period in different ways.

In term two you will explore the Crusades answering the question, 'Did people go on Crusades simply to get in to heaven'.

Much of history is focused around debates and as such, each half term will look at a different enquiry question. As well as looking at key periods in history, it is also useful to look at how much things have changed over time. To do this, we also focus on one key area and track this over a long period of time. In Year 7, you will focus on change over time through studying public health from the Romans through to the 20th Century. Finally, in term three we will examine the Early Modern period with a particular emphasis on the War of the Roses.

## EXTRA OPPORTUNITIES

History is a subject where you can explore far and wide. Our homeworks often focus on independent research this year we launched KS3 History club. We also take an annual trip to Warkworth.

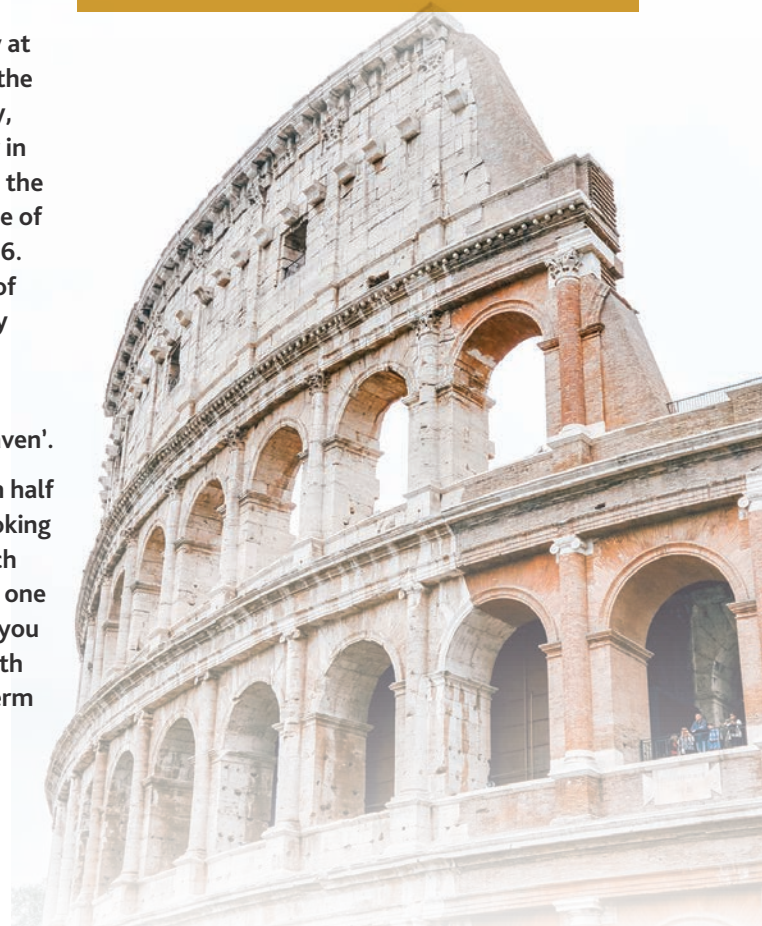



Geography at Whickham aims to give you the tools to explain the world around you. In Year 7 this will take a thematic approach where a series of stand-alone topics will be studied and then brought together in Years 8 and 9 to explain the geography of places, such as the Democratic Republic of Congo, Haiti and Russia.

The first theme in Year 7 looks at place and location and how they are represented through maps. To do this we will firstly look at representations of places on the Earth and how they have changed through time. We will then focus upon how places are located on maps and the detail that maps can illustrate about a place. This will be followed by our second theme exploring the value of rivers to a society and how rivers, through their journey from source to mouth, shape the land that they travel through. After this, our

third theme focuses on development and asks why a gap between the most and least developed countries exists? Lessons will then evaluate attempts by countries and organisations to close the gap. The next theme looks at a topic that is of importance to an island nation like Great Britain - the coast. We will explore how the landforms along the coastline of Great Britain have been created and finish by looking at whether battling the forces that create the coastline can be managed or not. Year 7 in Geography will conclude by asking whether Malthus, a cleric and economist writing at the end of the 19th Century, was right to suggest that population growth would outstrip resources available and ultimately decline through famine, disease and pestilence.

# Geography



## EXTRA OPPORTUNITIES

There is Geography in everything that each of us does every day. Extra-curricular activities in Geography will reflect this. There will be Geography club open to Year 7 that will focus upon student activism for climate change and other environmental issues, such as palm oil. There will also be opportunities to explore topics in greater detail by listening to podcasts, watching documentaries and reading books that are linked to the topics being studied in Year 7. Finally, and most importantly, Geography is also about applying what is learnt in the classroom to the world outside. There will be opportunities for fieldwork and research of places linked to topics being studied to show that the world is a 'messier' place than neat theories explored in the classroom suggest.



# Religious Education

In Year 7 we will explore lots of different aspects of the world around us - we look at the ideas of people who follow the main religions in the world and those who have no faith, through moral issues and big questions. We definitely ask more questions than we have answers!

We will start off looking at ultimate questions; it's an introduction to the way people think and the big

questions that the world has. This can be everything from "does God exist?" to "what is the best part of a fork?"

We will then, over the next 2 terms, look at Islam and Judaism, their beliefs and practices and we can compare and contrast these 2 Abrahamic faiths, as well as how they approach moral questions such as "should we eat meat?" and "How can we protect the environment?"

## EXTRA OPPORTUNITIES

There are religious and moral issues all around us. We have an "RE in the news" board which we will update weekly and you will have plenty of time to discuss these issues in tutor time.

There is also a KS3 debating society in which you can discuss any issues that interest you! We always look at both points of view. It's great for both building up skills to help your written work but also if you like getting stuck into a good argument!



In Year 7 ICT you will learn new skills and also build on the skills you have acquired through KS2. You will work on a range of different topics which will improve your confidence in the subject. These topics, delivered with real world examples, have an aim to prepare you for when you leave school. You will work independently and in groups on learning the following topics:

- Being safe online.
- Working remotely on cloud applications.
- Programming multiple different languages including Scratch or Small basic.
- Spreadsheet creation and understanding.

The homework you complete will be contributing towards your iDEA bronze award, which is an industry recognised award which helps you stand out from the crowd.

**iDEA - (Inspiring Digital Enterprise Award).** The aim of this is to develop digital, enterprise and employability skills for free. Feel free to read up about this at: [www.idea.org.uk/about](http://www.idea.org.uk/about)

The more our world relies on technology, it is even more important that you are introduced to and are confident in key topic areas to ensure you are prepared for the future.

## I.C.T.

### EXTRA OPPORTUNITIES

Activities include code clubs, where you will fine tune your coding skills to work independently on tasks/games. One website we use is <https://code.org/>. Why not give it a go so you have a head start for September?

We have recently signed up to Amazon Web Services (AWS) to encourage girls aged 12-13 to consider a career in tech. This involves workshops delivered by Amazon with the aim of competing in an app-building competition to solve real issues faced by their school or community.



# DESIGN TECHNOLOGY

## Y7 DT Food Technology overview:

In Year 7 Food Technology you will be introduced to the methods, equipment and appliances that will allow you to plan and produce food dishes safely and hygienically in the kitchen. You will develop your confidence in the following practical areas:

- **Using the oven - using the hob, main oven and top oven for boiling, baking and grilling safely.**
- **Using small appliances - using hand blenders for a variety of hot and cold dishes.**
- **Using knives - using knives to develop precise and accurate cutting, chopping and garnishing.**

You will also investigate why the food we eat is important for our bodies and the world around us. You will look at what influences our food choices by exploring the principles of nutrition for a healthy diet whilst considering the impact of food miles and seasonality on the environment.

Food Technology will enable you to apply principles of healthy eating to your own diet and the diet of others when cooking a range of foods at school and at home. You will learn how to use your creativity to make food exciting and imaginative when feeding yourself and others!

## Y7 DT Product Design overview:

In Year 7 Product Design and engineering you will start to build up your confidence and skills in a workshop environment across a range of projects. In Year 7 there is a focus on plastics and how these impact the environment and how you can cut and shape them. You will learn how to use both hand tools and machines in a safe manner while creating a clock based from a well known design movement, developing your communication skills as well as working as part of a team by making a bridge in engineering. You will develop your presentation skills by drawing design ideas from one point perspective and isometric while adding tone and shade. Students will learn the whole design process from start to finish- analysing a brief, understanding the wants and needs of a client, product specification, product analysis, initial designs, design development and evaluation. Design Technology and engineering allows you to build your creativity, problem solving, mathematical, communication and organisation skills.

## EXTRA OPPORTUNITIES

Formula 24 Green Power Race Team - Friday after school. Students are manufacturing a car from scratch, they have made the parts and wiring to race.

STEM based projects which combine maths and science alongside design and technology will take place one lunch time a week.

The Robotics club which runs after school, will teach you how to work as a team, how to build a robot to compete and defeat other schools within the area.





The background of the page is a large, stylized French flag with vertical stripes of blue, white, and red. The word 'FRENCH' is written in a blue, graffiti-style font across the white stripe.

# FRENCH

# Modern Foreign Languages

**We hope you are excited and ready to learn a new language at Whickham School!**

Year 7 Modern Foreign Languages begins with greetings, introductions and exchanging information so there's no need to worry if you have studied a different language in primary school as you will be able to take part in spontaneous conversations very quickly!

The rest of Modern Foreign Languages covers a variety of topics such as My Family, Pets and other Animals, Food and Drink, My House and Area and My School, Appearance and Personality, Music and TV.

For each topic you will learn a range of new vocabulary which will allow you to ask questions and give opinions with reasons as well as learning about German and French culture and the way of life.

Each half term you will cover all four skills which are Listening, Reading, Speaking and Writing so that you feel confident communicating in different ways. As well as these four fundamental skills, you will also improve your level of vocabulary and understanding of grammar using online platforms such as Memrise, Quizlet and Languages Online.

Learning about the culture of French and German speaking countries is very important and is something that is covered throughout the year including European Day of Languages, a francophone Christmas, Gastronomy and Bastille Day, Oktoberfest and Carnival . We will study a French film called 'Les Choristes' to help us with the My School topic and in German we will study post war history with a film 'das Wunder von Bern'.

Learning a new language is all about having the confidence to make mistakes and giving things a go. We're looking forward to meeting you in September and hearing you speak some wonderful new Languages!

## EXTRA OPPORTUNITIES

For extra curricular activities there will be a French and German café later in the year where you can put your knowledge of Food and Drink to good use by ordering some authentic French and German cuisine!

As well as this, you could be nominated for Linguist of the Lesson by your teacher and there will be regular Quizlet and Memrise competitions throughout the year to see who has learned the most vocabulary.

The bottom of the page features a large, stylized German flag with horizontal stripes of black, red, and gold. The word 'GERMAN' is written in a white, graffiti-style font across the black stripe.

# GERMAN





# SCIENCE

In Year 7 Science, you will build on your scientific knowledge gained at KS2.

The biggest difference is that we have labs where you will get the opportunity to do some exciting experiments!

At the start of the year, you will be taught how to think like a scientist and how to work safely in a laboratory, which is extremely important.

You will follow a course that is supported by an online resource called **Kerboodle Activate**, so if you are at home you are never stuck for information.

In Year 7 you will learn about different aspects of Chemistry, Physics and Biology.

You will start with "Working Scientifically", which gets you to think like a scientist and develops your skills of collecting and analysing data, designing experiments and interpreting and evaluating results. In Biology you will go on to study about cells, the structure and function of body systems and reproduction!

In Chemistry you will learn about particles, atoms and elements, acids and alkalis and some chemical reactions. In Physics you will learn about forces, sound, light and space.

What is most important to us at Whickham School is that you enjoy science, have some fun and that you always try your best!

## OPTIONAL EXTRAS

We hold an exciting STEAM club which allows you to explore and investigate why science plays such an important part of everyday life and gives you the opportunity to investigate your own scientific questions.

There are also opportunities for you to take part in various external STEAM activities such as the amazing Marine Engineering workshop run by the Sea Cadets which explores the fundamentals of buoyancy and why things float.

Our leading edge projects run by the University of Newcastle gives you the opportunity to work on a lab based research project in a real university laboratory. This not only is a lot of fun but it gives you an insight of what it would be like to work as a scientist as a career or as a graduate.

# Uniform

## ALL PUPILS

## DETAILS

## HOW TO WEAR THE SCHOOL UNIFORM

<b>Shirt</b>	Plain white traditional school shirt with collar. Shirt sleeves may be long or short	<ul style="list-style-type: none"> <li>• Pupils ensure that collar button is fastened at all times</li> <li>• Pupils not to wear coloured vests beneath shirts</li> <li>• No fashion shirts/blouses</li> <li>• Tuck shirt into trousers/skirt</li> </ul>
<b>Tie</b>	School tie	<ul style="list-style-type: none"> <li>• Clip-on school tie</li> </ul>
<b>Blazer</b>	School blazer with embroidered school badge	<ul style="list-style-type: none"> <li>• Blazer must be worn when travelling to and from school and when transiting between lessons</li> <li>• Removal of blazers during the lesson is at the discretion of the teacher</li> <li>• Sleeves must be worn at full length (not pushed back)</li> </ul>
<b>Trousers</b>	Plain black, tailored straight legged school trousers	<ul style="list-style-type: none"> <li>• Approved black school trousers from designated supplier</li> <li>• Not skin tight or elastic material</li> </ul>
<b>Skirt</b>	School skirt purchased from designated supplier	<ul style="list-style-type: none"> <li>• Approved style only</li> <li>• Skirt length should be knee length</li> </ul>
<b>Shoes</b>	Plain black, laced, polishable school shoes	<ul style="list-style-type: none"> <li>• Must be lace up or velcro</li> <li>• No trainers or trainer style shoes</li> <li>• For safety reasons, no ballet-type shoes, no flip-flops, sandals, plimsolls, backless, slip-on shoes, boots or 'Uggs'</li> </ul>
<b>Outer clothing</b>	Dark coat or jacket, preferably waterproof	<ul style="list-style-type: none"> <li>• No hooded tops, sweatshirts, or tracksuit tops</li> <li>• No denim, leather or leather-look garments</li> </ul>
<b>School bag</b>	Minimum size to hold at least an A4-sized folder	<ul style="list-style-type: none"> <li>• Suitable schoolbag, not a handbag</li> <li>• Plain, dark colour</li> </ul>
<b>Make up</b>		<ul style="list-style-type: none"> <li>• Make up should not be worn or brought into school</li> <li>• No nail varnish</li> <li>• No false / acrylic nails</li> </ul>
<b>Jewellery</b>	No jewellery	<ul style="list-style-type: none"> <li>• Pupils must not wear jewellery or piercings of any description for school. This includes plastic retainers</li> </ul>
<b>Haircuts</b>	Smart appearance. Natural hair colours only. Eyebrows must not be shaved.	<ul style="list-style-type: none"> <li>• No extremes of fashion eg Mohican style, no 'v' shape style, rats tails etc</li> <li>• No 'tramlines' or shapes shaved into hair</li> <li>• 'Number 2' haircut is the minimum length allowed</li> </ul>
<b>Socks/Tights</b>	Plain black socks or tights	

# Uniform & PE Kit



## 1. Please order all school uniforms online where possible.

School uniforms may be ordered online via our website, at [www.michaelsehgal.co.uk](http://www.michaelsehgal.co.uk).

## 2. Order early! Especially for New Starters' uniforms!

We predict a surge in demand so we strongly advise all parents to order uniform as soon as possible and in particular, the uniforms for new starter students should be ordered before 30th June! If sizes run out, they are likely to take longer than normal to replenish as a result of supply chain disruption. So our advice is to order early to avoid shortages. Please do not wait until July or August!

## 3. Get Free Delivery and Free Returns on orders placed by 30th June.

Free delivery and returns is available for a limited time in May and June only, so order during this time and even if the size isn't right, there will be no delivery or return costs up to the 30th of June. Just insert the discount code: FREEDELIVERY21 at the checkout.

## 4. Our customer services team is here to help!

Sizing guides are available on our website, indicating the most popular sizes, per age group and our customer services team can help you with your order, if it's the first time you are ordering. Call us for assistance on **0191 230 2320** or, email us at [sales@michaelsehgal.co.uk](mailto:sales@michaelsehgal.co.uk). You can also find the answers to most frequently asked questions at: [www.michaelsehgal.co.uk/faqs/](http://www.michaelsehgal.co.uk/faqs/).

## 5. We will keep you informed!

At every stage, including ordering, processing and dispatch you will receive notifications from us to advise you of the status of your order. We aim to deliver all school uniforms safely and promptly.

**Michael Sehgal and Son, 28-40,  
Scotswood Road, Newcastle, NE4 7JB.  
Tel: 0191 230 2320  
[www.michaelsehgal.co.uk](http://www.michaelsehgal.co.uk)**





## Cashless Catering: Biometric

### The system works in the following way:

- Pupils are enrolled onto the system.
- Enrolling means the computer software will take a digital image of your child's finger and turn it into numbers (not the actual finger print image) which are stored on the school server.
- Every time your child's finger image is re-read a number is generated. This is unique to your child.
- Pupils will pay in advance for their lunches by using either the pay-in point outside the dining hall or parents can pay for school meals using a credit or debit card online using ParentPay, meaning that pupils don't need to bring money into school. This is the preferred method
- Pupils are identified at the till from their finger image, and the cost of their meal taken off their account.
- Your child will not need to remember to bring anything with them to the dining hall.
- It can be cheaper because pupils will never need to replace a lost or damaged card.
- Parents can pay for school meals using a credit or debit card online using [ParentPay](#), meaning that pupils don't need to bring money into school.

As we hold personal data about your child we must provide you with a Fair Processing Notice. We are meeting the requirements of the Data Protection Act because:

1. The finger image data will only be used by the school and not passed to anyone else.
2. The data is safe and secure on our school server.
3. When your child leaves Whickham School the data will be destroyed.

## Free School Meals - Are You Entitled?

### How can my children receive school meals?

Your child, or children, may qualify for free school meals if you are able to meet the following criteria:

You or your partner must have a child or children for whom you receive child benefit who is in full time education, under 19 years of age and who attends a local authority school or sixth form.

You and your partner must be in receipt of one of the following benefits:

- [Income Support](#).
- [Income Based Job Seekers Allowance \(JSA - IB\)](#).
- [Guarantee Pension Credit](#).
- [Employment and Support Allowance \(ESA Income Related\)](#).
- [Child Tax Credit - but not Working Tax Credit - and your income for Tax Credit purposes must be less than £16,190.00 \(details are shown on your Tax Credit award notice\)](#).
- [Working Tax Credit run-on - paid for 4 weeks after you stop qualifying for Working Tax Credit](#).
- [Universal Credit](#).

If this applies to you, please pick up a Free School Meals Application Form available at the School Office.

# ParentPay -

## Our online Payment Service



Whickham School is striving to become a cashless school and therefore we are pleased to inform you that the school has the facility to accept online payments for school meals, trips and other school activities using a secure website called Parentpay. Parentpay allows the benefit to be able to pay online using your credit or debit card.

Parentpay is easy-to-use and will offer you the freedom to make online payments whenever and wherever you like, 24 hours a day, 7 days a week- safe in the knowledge that the technology used is of the highest internet security available and that funds will reach school safely.

Parents will have a secure online account, activated using a unique username and password; making a payment using your credit or debit card is straightforward and no card details are stored on the system or are accessible by the school or Parentpay.

When you make a payment, an e-mail confirmation is sent to you, giving you reassurance that the transaction has been successful and Parentpay will hold an electronic record of all online payments for you to view at a later date.

Within Parentpay you will be able to access the extended facilities which allow parents to view the

catering menu offers week by week, and to also view what your son/daughter has purchased each day.

You will also be able to view trip payments and balances and set reminders if you are paying in instalments for any of your purchases. In addition, Parentpay offers you the ability to set automated email/SMS reminders ensuring you never miss a payment.

An account activation username and password will be sent out to you from the school before your son/daughter starts in September. You will be prompted to change these and to keep your new username and password safe and secure. Full details on how to activate your account and start making payments will be included.

Please look out for our new On-line Shop. The shop facility can be accessed - without logging in - from the "Parents" tab on the school's website. Items available to purchase from the On-line Shop will include starter packs and ties.

**We thank you in advance for your support in using Parentpay.**

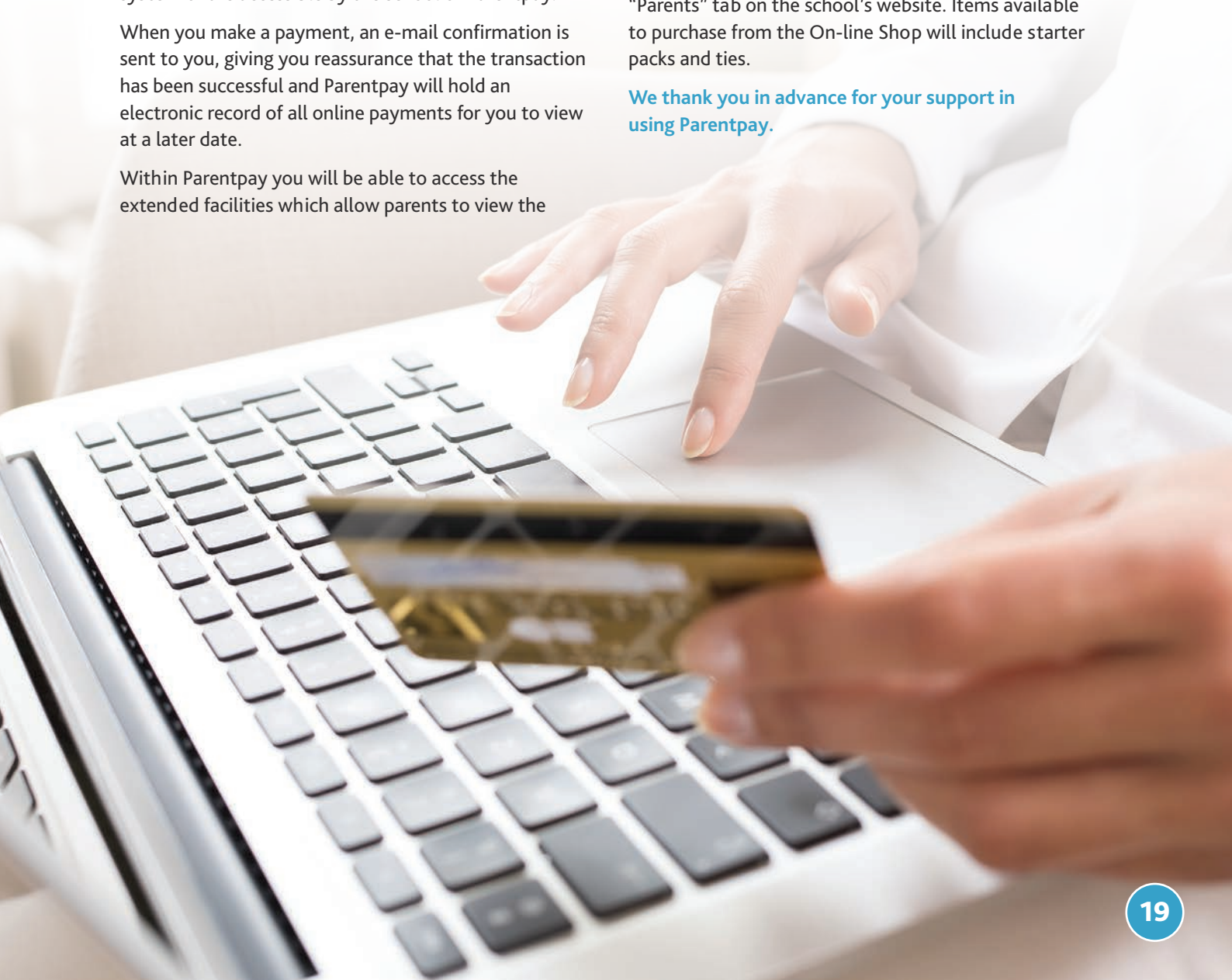



# Attendance Matters

Whickham School offers an exceptional learning environment where pupils are happy and want to attend.

- Attendance is one of the most important elements in what makes a successful pupil.
- We actively celebrate excellent attendance with termly prizes and annual certificates. Whickham pupils should be proud of their achievements and understand the significance attendance has on their further education and future employment choices.

However the real prize is the impact it has on their GCSE results clearly illustrated (right):

At Whickham school we expect our pupils to attend at **least 98%** of the time. This equates to no more than 4 days of absence across an academic year.

- If your child is sick, you have a legal requirement to inform school on each day of absence. You can call the school's absence line on **0191 496 0026** to speak to a member of staff or leave a message clearly stating the reason for absence. Just reporting that your child is 'poorly' or 'under the weather' is not enough, please let us know the reason/condition that is preventing school attendance.
- If you fail to inform the school, we are legally required to make contact with you or any other named contact.
- Wherever possible, all non-emergency appointments should be made out of school hours. Where appointments are made during school hours, there is an expectation that your child attends school before and after the appointment to minimise lost learning.

Chances of Success at GCSE

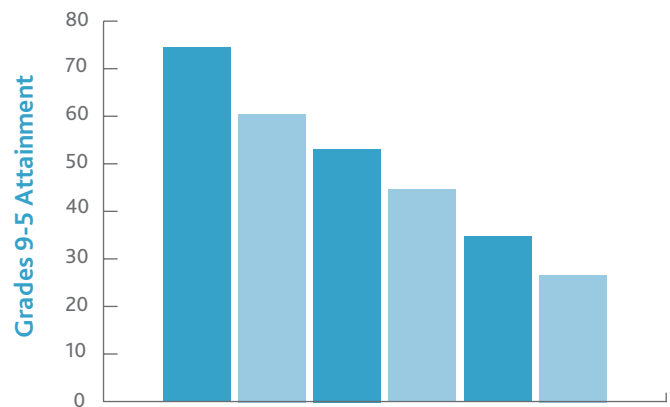

All appointments must be substantiated by evidence.

- Examples of medical evidence include: Doctor's notes, prescriptions, labels from prescribed medication obtained during the period of absence, appointment letters/cards and referral letters.
- Without these documents, we are unable to authorise absences.
- As a school we are required to follow legal processes and have statutory duties and expectations from the Local Authority. Legal proceedings can continue across academic years, so if attendance is poor and unauthorised at the end of the year, monitoring and referrals will continue into the new academic year in September.
- We work very hard with our pupils and families to avoid legal proceedings and communication is the key to a successful relationship with school.
- We look forward to working together to ensure that your child succeeds and thrives at Whickham School.



Our strategy to ensure attendance expectations are met fall into five stages.

Whilst we will always include cumulative attendance percentages on all correspondence with parents/ carers, our strategy is based on the number of days of absence in relation to the maximum achievable attendance in an academic year.

Attendance	Lost Learning	Outcome / Intervention
<b>100%</b>	<b>Nothing missed Everything gained</b>	Every chance of outstanding success.
<b>99.5%</b>	<b>1 Day 5 Lessons</b> Within expectation.	<b>STAGE 1 WITHIN EXPECTATIONS</b> <b>Great chance of success</b> You must call the attendance line to report any absences by 9AM. We understand that sometimes children are poorly but would ask you to prepare your family for the world of work where absences often go unpaid. Please try to make medical and dental appointments out of school hours. Evidence will be required for absences due to appointments.
<b>99%</b>	<b>2 Days 10 Lessons</b> Within expectation.	
<b>98%</b>	<b>4 Days 20 Lessons</b> Within expectation.	
<b>97.99%</b>	<b>Over 4 days Over 20 lessons</b> Below expectation Catch up required.	<b>STAGE 2 BELOW EXPECTATIONS</b> A letter will be sent home to remind parents/carers of our expectations. <b>ADDITIONAL WORK WILL BE NECESSARY FOR LESSONS MISSED.</b>
<b>95%</b>	<b>9.5 Days 45 Lessons</b> Worrying, chances of falling behind impacting on success.	<b>STAGE 3 BELOW EXPECTATIONS</b> We'll invite Parents/Carers into school for an informal meeting with a view to addressing any barriers to attending school. We aim to resolve issues and put attendance incentives in place.
<b>92%</b>	<b>15 Days 70 Lessons</b> Less likely to succeed and harder to make progress.	<b>STAGE 4 SERIOUSLY BELOW EXPECTATIONS</b> We'll invite Parents/Carers into School for a formal meeting with Senior Leadership and the Board of Governors. During this meeting, we'll establish the need for any necessary support from external agencies. <b>PUPILS WILL BE PUT ON ATTENDANCE REPORT AND A FOUR WEEK REVIEW PERIOD WILL BE AGREED.</b>
<b>90%</b>	<b>19 Days 95 Lessons</b> Likely to have a detrimental effect on achievement and life chances.	<b>STAGE 5 CRITICAL</b> At this stage pupils have reached Persistent Absentee Status. We'll assess the interventions put in place during previous stage and where necessary pursue <b>LEGAL INTERVENTION</b> . Penalty Notices are a minimum of £60 per parent/carer.

\*Medical evidence can include any of the following: Doctor's notes, prescriptions, Labels from prescribed medication obtained during the period of absence, appointment letters/cards, referral letters.

Should your child become too poorly to attend school, please ensure that you call the school absence line by 9am; you must call every day of your child's absence. Please take a moment to read the following guide to common illnesses and the anticipated impact they may have on your child's attendance:

<b>CONJUNCTIVITIS</b>	Consult GP or Pharmacy. Try not to touch your eye to avoid spread. Continue to attend school.
<b>GLANDULAR FEVER HAND, FOOT &amp; MOUTH HEAD LICE SLAPPED CHEEK THREADWORMS TONSILITUS RINGWORM PERIOD PAINS</b>	Consult GP or Pharmacy. Try not to touch your eye to avoid spread. Continue to attend school.
<b>COMMON COLD</b>	Continue to attend and practice good hand hygiene.
<b>CHICKEN POX</b>	Consult GP or Pharmacy. Try not to touch your eye to avoid spread. Continue to attend school.
<b>FLU</b>	Consult GP or Pharmacy. Often confused for common cold. Return to school 5 days after onset of illness.
<b>MEASLES</b>	Consult GP. Return to school 4 days after rash appears.
<b>MUMPS</b>	Consult GP. Return to school 4 days after swelling appears.
<b>WHOOPING COUGH</b>	Consult GP. Return to school 5 days after start of antibiotics or 21 days after start of illness.
<b>IMPETIGO</b>	Consult GP. Return to school when scabs are dry or 48hrs after start of antibiotics.
<b>SCABIES</b>	Consult GP. Return to school after first treatment.
<b>SCARLETT FEVER</b>	Consult GP. Return to school 24hrs after start of antibiotics.
<b>SHINGLES</b>	Consult GP. Only stay off if the rash is weeping and cannot be covered.
<b>DIARRHOEA OR VOMITING</b>	Consult GP if symptoms persist after 48 hours. Only take time off when symptoms are persistent.

See [www.patient.co.uk](http://www.patient.co.uk) for further information on each of these conditions.

## Leave Of Absence Requests (LOA)

We review LOA requests on a case by case basis, but as a general rule we do not approve leave of absence, unless there are exceptional circumstances.

Forms can be found on our website or online form and sent to the Attendance Officer.

Response to requests will be sent via Text Message.

Unauthorised absences can result in Legal Intervention and the possible issue of a 'fixed penalty notice' of £60 per parent carer which rises to £120 if not paid within 21 days.

The school is extremely thorough when investigating prolonged absences. We trust our parents to be honest with us and inform us of planned absences and holidays, no matter the potential outcome.

LOA requests should be submitted at least 4 weeks in advance to allow pupils to plan around missed work.

The average academic year is 190 days long, please make every day count. Wherever possible please use weekends and holidays for everything else.



## Punctuality

Punctuality is an essential life skill which transfers into adulthood. We expect our pupils to be in school on time, every day.

The first bell rings at 08:35 allowing 5 minutes of movement time before pupils should be at their classrooms and ready to take their seats at 08:40. It is expected that all pupils are inside the school gates before 08:35. Arriving late results in lost learning.

Students will receive a 20 minute lunchtime detention if they are late to school. Failure to attend will result in a 60 minute detention on Thursday after school.

Students are reminded that they should be in school at 08:35 am each morning.

### Lateness to lessons

If a student is late to lessons twice in a week or for a total of 15 minutes or more each week, they will receive a 60 minute after school detention.

Please encourage your child to get a good night's sleep and take responsibility for setting their own alarm.

Whickham is a busy area, so please factor in the traffic. It's better to be early than late.

MINUTES LATE LOST	LEARNING DAYS LOST
5 minutes each day	3 days per year
10 minutes each day	6.5 days per year
15 minutes each day	10 days per year
20 minutes each day	13 days per year
30 minutes each day	19 days per year

## Home Visits

Home visits can be made to check on the wellbeing of a pupil for one of the following reasons:

- No contact for the absence of a pupil
- School refusal
- Poor Attendance
- Long term illness support
- Safeguarding concerns

Home visits are part of our continued support of pupils and their families.



## Frequently Asked Questions

---

**Parent: My child is just having an 'off day' so I'm not sending him/her in'**

**School:** Having sporadic days off school can quickly add up. We always want to encourage pupils to attend, sometimes getting out of bed, showering and putting on a uniform is all it takes to feel a little better. Coming to school on days when you don't really feel like it can make a big difference. We will always send pupils home if they are genuinely unwell.

---

**Parent: My child was sick over the weekend, should I keep him/her at home?**

**School:** We don't have a fixed 48hr rule for diarrhoea and sickness. If your child has had an isolated incident and is feeling better, please send them to school.

---

**Parent: I have received an attendance letter and I do not like the tone.**

**School:** We're sorry you feel that way but we have to state facts and legal information to make things clear. Each correspondence forms part of a possible legal intervention and must leave no ambiguity.

---

**Parent: I can't provide medical evidence because it's impossible to get a GP appointment.**

**School:** Wherever possible, we will request medical evidence. If your child is off for 4 consecutive days, we will expect a GP visit. If your child has had several shorter absences for the same condition, we will also expect a GP visit. Medical evidence makes the difference between authorised absence and unauthorised absence. We do not pursue legal intervention where medical evidence is provided. It's as important for you as it is for us.

---

**Parent: I do not like being challenged regarding my child's absences and reserve the right to make the decision as to whether my child is well enough to attend school.**

**School:** We are sorry you feel that way but please bear in mind that our team are simply doing their jobs in complying with school rules and statutory guidance. It's not personal and ultimately we can offer a multitude of support to help your child's attendance improve and safeguard their future success. Remember, we care.

---

**Parent: Why do I have to tell you the details when my child is unwell?**

**School:** Firstly, your conversation with us is confidential. We do not share details with the wider school community but will need to know exactly what's wrong so that we can offer the right level of support and guidance. We care for every aspect of your child's health and wellbeing from migraines to mental health. Good communication will help us to help you.

---

**Parent: Why do I need to call school every day when my child is absent?**

**School:** Put simply, we have a duty of care and cannot assume that your child is at home. A daily call to us will give both school and home the confidence of knowing that your child is safe.

---

**Parent: I cannot take your calls or make meetings due to work commitments.**

**School:** We will endeavour to work around your schedule in the interest of your child. Conversations and face to face meetings are important in building relationships. Family dynamics are unique and so are the interventions we can put in place to help your child to overcome barriers to attendance.

---

**Parent: My child is anxious and their attendance has dropped, but you want to meet me to discuss this matter. You know why they can't attend, what is the point of this meeting?**

**School:** Our meetings are intended to be supportive. We have a team of mental health first aiders in school along with a dedicated counsellor. If you are seeking external help it's important to send in your appointment letters and stay in touch.

# Scholars Transport Timetables

## September 2022-23\*

### MORNING SERVICES

#### 801 SERVICE - DEPARTS DIPTON, COOPERATIVE TERRACE 07:44

VIA: DIPTON Derwent View Terrace (07:46), Front Street, A692, FLINTHILL, Robson Terrace (07:50) **#CONNECTS WITH 713 FROM STANLEY & TANFIELD LEA TO ALLOW PUPILS TO TRANSFER TO 801**, White Le Head West Road, TANTOBIE, West Road, Front Street, Woodside Grove, TANFIELD VILLAGE Pack Horse (07:57), CROOKGATE Bank Top (08:00), PICKERING NOOK Syke Road (08:04), BURNOPFIELD Lintz Estate, Albion Gardens (08:07) Main Street, Post Office (08:15), Pack Horse (08:17), FELLSIDE ROAD, Woodmans Arms (08:26), Burnthouse Lane.

**ARRIVES WHICKHAM SCHOOL 08:30**

#### 889 SERVICE – DEPARTS SCOTLAND HEAD PARK LANE BUS STOP 07:45

VIA: VIA: Scotland Head Bus Stop, WINLATON BUS STATION Stand C (07:53), Bus Link, Mount Pleasant, Litchfield Lane, Tyne Street, PARK TERRACE (08:00), Shibdon Bank, Shibdon Road, Hexham Road, SWALWELL (08:15), Swalwell Bank, Fellside Road, Burnthouse Lane.

**ARRIVES WHICKHAM SCHOOL 08:25**

#### 890 SERVICE - DEPART BLACKHALL MILL CHOPWELL ROAD 07:30

VIA: Chopwell Road, Mill Road, Derwent Street Bus Stand (07:38), Hall Road, Clayton Terrace Road, East Street, Glossop Street, HIGH SPEN BUTE ARMS (07:48), Hookergate Lane, Hugar Road, Hookergate Lane, HIGHFIELD (07:54), Smailes Lane, Strathmore Road, Station Road, ROWLANDS GILL (08:00), Lockhaugh Road, SPA WELL ROAD (08:08), Hexham Road, SWALWELL (08:20), Swalwell Bank, Fellside Road, Burnthouse Lane.

**ARRIVES WHICKHAM SCHOOL 08:30**

#### 893 SERVICE –Via HIGH SPEN BUS STAND 07:35

Via: Strothers Road, Collingdon Road, Hookergate Lane, Hugar Road, Hookergate Lane, Smailes Lane, HIGHFIELD (07:44) Smailes Lane, Strathmore Road, Station Road, ROWLANDS GILL (07:50), Unclassified Road, Turn at end of road, SHERBURN TOWERS

TERMINUS (07:55), Unclassified Road, Lockhaugh Road, Spa Well Road, WINLATON MILL HUNTLEY CLUB (08:07) Hexham Road, SWALWELL (08:15), Swalwell Bank, Fellside Road, Burnthouse Lane.

**ARRIVE WHICKHAM SCHOOL 08:29**

#### 895 SERVICE – DEPARTS BYERMOOR 08:15

VIA: A692, MARLEY HILL (08:18), Church Street, Gateshead Road, Coronation Road, Kingsway, SUNNISIDE GLADELEY WAY (08:21), Burnthouse Lane, Broadway, (SET DOWN AT BUS STOP OPPOSITE COACHMAN PUB FOR CLOVER HILL JMI SCHOOL 08:25), Fellside Road, Burnthouse Lane, WHICKHAM SCHOOL TURNING CIRCLE (08:28), Fellside Road Front Street, SET DOWN AT BRIDLE PATH STOP FOR FRONT STREET SCHOOL (08:32), Front Street, Broom Lane, SET DOWN AT BUCK'S HILL VIEW FOR WASHINGWELL SCHOOL (08:37), Whaggs Lane, Rectory Lane, Front Street, Duckpool Lane SET DOWN FOR ST MARY'S SCHOOL (08:50)

**ARRIVES WHICKHAM COMP 08:28**

#### 898 SERVICE - DEPARTS KINGSMEADOW COMP SCH 08:05

VIA: Market Lane, Ellison Road, WILSON STREET (08:10), Cypress Crescent, Maple Avenue, Knightside Gardens, TOP OF KNIGHTSIDE GARDENS (08:15), Whickham Highway, Front Street, Fellside Road, Burnthouse Lane.

**ARRIVES WHICKHAM SCHOOL 08:25**

#### 899 SERVICE - DEPARTS SHIBDON ROAD 07:45

VIA: SHIBON ROAD, Shibdon Bank, Clavering Road, Shibdon Bank, Tyne Street, LITCHFIELD LANE (07:50) Blaydon Bank, Croftdale Road, Back Lane, NORTH STREET (07:55) Back Street, WINLATON BUS STATION (07:58) Back Street, Church Street, Scotland Head, Mill Lane, Holly Avenue, NOEL AVENUE (08:03) A694 Spa Well Road, Hexham Road, SWALWELL BANK (08:15) Whickham Bank, Fellside Road, Burnthouse Lane.

**ARRIVES WHICKHAM SCHOOL 08:25**

\* Bus timetables can be subject to change.



## AFTERNOON SERVICES

### 801 SERVICE - DEPARTS WHICKHAM SCHOOL 15:20

VIA: Burnthouse Lane, FELLSIDE ROAD, Woodmans Arms (15:24), Pack Horse, BURNOPFIELD Post office (15:30), Lintz Estate (15:35), PICKERING NOOK Syke Road (15:40), CROOKGATE Bank Top, TANFIELD VILLAGE Pack Horse (15:48), Sleepy Valley, FLINTHILL, Robson Terrace (15:57), #CONNECTS WITH 714 FOR STUDENTS WANTING TO TRAVEL TO TANFIELD LEA & STANLEY, DIPTON Derwent View Terrace (16:01).

**ARRIVES DIPTON COOPERATIVE TERRACE 16:03**

### 893 SERVICE - DEPARTS WHICKHAM SCHOOL 15:25

VIA: Burnthouse Lane, Fellside Road, Whickham Bank, Hexham Road, Spa Well Road (15:35) Lockhaugh Road, Unclassified Road, Turn at end of road, SHERBURN TOWERS TERMINUS(15:40) Unclassified Road, Station Road, ROWLANDS GILL (15:43), Strathmore Road, Smailes Lane, HIGHFIELD (15:46,) Hookergate Lane, Hugar Road, Hookergate Lane, HIGH SPEN BUTE ARMS (15:49), Collingdon Road, Ramsay Street, Strothers Road.

**ARRIVES HIGH SPEN BUS STAND 15:50**

### 896 SERVICE - DEPARTS WHICKHAM SCHOOL 15:25

VIA: Burnthouse Lane, Fellside Road, Broadway, Burnthouse Lane, Kingsway, SUNNISIDE GLADELEY WAY (15:30), Coronation Road, Gateshead Road, Church Street, Lobley Hill Road, BYERMOOR PACK HORSE (15:38), B6310, New Road, Busty Bank Foot, Burnopfield Road, Stirling Lane, ROWLANDS GILL TESCO (15:44) Station Road, Stathmore Road, Smailes Lane, HIGHFIELD PRIMARY SCHOOL (15:48), Smailes Lane, Hookergate Lane, HIGH SPEN BUTE ARMS (15:55) Ramsay Street, Strothers Road.

**ARRIVES HIGH SPEN BUS STAND 15:58**

### 897 SERVICE - DEPARTS WHICKHAM SCHOOL 15:25

VIA: Burnthouse Lane, Fellside Road, Whickham Bank, Hexham Road, Spa Well Road, (15:35) ,

Lockhaugh Road, Unclassified Road, Turn at end of road, SHERBURN TOWERS TERMINUS (15:40) Unclassified Road, Station Road, ROWLANDS GILL (15:43), Strathmore Road, Smailes Lane, HIGHFIELD (15:46), Hookergate Lane, Hugar Road, Hookergate Lane, HIGH SPEN BUTE ARMS (15:50), Glossip Street, East Street, Clayton Terrace Road, Hall Road, Derwent Street Bus Stand (15:57), Derwent Street, Mill Road, Chopwell Road.

**ARRIVES BLACKHALL MILL (CHOPWELL ROAD)16:00**

### 898 SERVICE - DEPARTS WHICKHAM SCHOOL 15:25

VIA: Fellside Road, Front Street, Whickham Highway, Knightside Gardens(15:35), Maple Avenue, Cypress Crescent, Wilson Street, Ellison Road, DUNSTON FOUR LANE ENDS (15:38), Market Lane, SWALWELL (15:40) Hexham Road, Shibdon Road Shibdon Bank, Tyne Street, Litchfield Terrace, Mount Pleasant Bus Link, WINLATON BUS STATION (15:48), Back Street, Church Street SCOTLAND HEAD.

**ARRIVE SCOTLAND HEAD WINLATON 15:50**

### 899 SERVICE - DEPARTS WHICKHAM SCHOOL 15:25

VIA: Burnthouse Lane, Fellside Road, Whickham Bank, Swalwell Bank, Hexham Road, RUGBY CLUB (15:32) Hexham Road, A694 Spa Well Road, NOEL AVENUE (15:38) Holly Avenue, Mill Lane, SCOTLAND HEAD (15:41) Church Street, Back Street, WINLATON BUS STATION (15:43) North Street, Back Lane, Croftdale Road, Blaydon Bank, LITCHFIELD LANE (15:46), Tyne Street, Shibdon Bank, Shibon Road.

**ARRIVE SHIBDON ROAD 15:50**

# BEHAVIOURAL EXPECTATIONS



## Uniform and Appearance

- **Whickham School blazer**
- **White shirt (tucked in)**
- **Whickham School skirt or trousers**
- **Year group tie**
- **Black leather polished shoes**
- **Must have equipment pack / pencil case**
- **No trainers**
- **No jewellery**
- **No false nails / No coloured nail varnish**
- **No extreme hair styles, unnatural or two tone colours.**

**FOLLOW STAFF INSTRUCTIONS AT ALL TIMES**



**Mobile phones must be switched off and in bags.**

**No earphones in School.**

## CHEWING GUM IS BANNED

Litter and chewing gum have a significant detrimental impact on the school site. If you drop litter or are found with chewing gum you will receive an

**• AUTOMATIC DETENTION •**



# Our Safeguarding Children Process

1

I have a safeguarding concern relating to a child, parent or member of staff

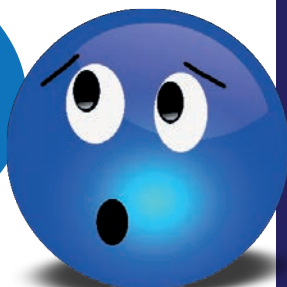

2

Contact one of the people below if it is about a child or parent and make a record of this on CPOMS. If it refers to a member of staff, please contact Mr F Turnbull  
[turnbullf@whickhamschool.org](mailto:turnbullf@whickhamschool.org)

3

Inform a member of the Safeguarding Team

Designated Safeguarding Lead



**Mrs S Maher**  
Deputy Headteacher - Pastoral

Designated Safeguarding Deputy



**Mrs S MacPherson**  
Deputy Safeguarding Lead

Designated Safeguarding Deputy



**Mr J McCaughey**  
Senior Pastoral Leader

Designated Safeguarding Deputy



**Mr M Phillipson**  
Assistant Headteacher - Behaviour and Welfare

4

Advice will be given on the next steps



This may or may not involve actions to be taken by the referrer

5

A plan will be put in place



This may or may not involve a referral to Social Care

6

Feedback to the referrer

Where appropriate the Designated Safeguarding Lead will give feedback. In some incidences the case details may be confidential.

Other useful contacts:

**Children's Social Care**  
Tel: 0191 433 2653  
Out of hours:  
0191 477 0844

**Police**  
Tel: 101  
(non-emergency)  
Tel: 999  
(emergency)

**NSPCC**  
Tel: 0800 800 5000



# THE ACHIEVEMENT TEAM

## A warm welcome from the Whickham School Achievement Team!

### Who are we?

**Mr Berry - Achievement and Intervention Leader**

**Mrs Hughes - Achievement officer**

**Miss Envy - Achievement officer**

**Miss Balmain - Achievement officer**

**Mrs Ross - KS5 Achievement officer and Careers Leader**

### What is our main ethos?

We believe that every pupil can and should achieve their full potential. We realise that pupils will need support to ensure they do so, and we are here to remove academic barriers to learning so that pupils can achieve their full potential. Our aim is to ensure that the overwhelming majority of pupils attend school, lessons and complete their homework, which will result in pupils who make good progress and achieve strong outcomes.

### What do we do?

We undertake a number of projects and interventions designed to support pupils in making the best progress they can and improve their attitudes to learning. Our work is centred around 3 main values:

#### • Attendance • Lessons • Homework

We work closely with the pastoral team to ensure attendance is strong. If pupils are not in school, they cannot attend lessons. To support pupil learning and homework completion we undertake the following interventions:

- **Academic mentoring** - We mentor a wide range of pupils who need support in a specific subject or general help in improving their all-round learning habits. This ranges from short drop in to longer 1:2:1 sessions.
- **Tutor time interventions** - We coordinate interventions across a wide range of subjects that give pupils booster sessions to improve their progress across the curriculum. This also includes a highly successful reading intervention where KS3 students read to members of our Sixth Form.
- **Homework hubs** - These run every lunchtime for all

year groups and after school each night. While anyone can attend after school, each year group has a night signposted for them to have priority over computer access and pupils who fall behind with homework are expected to attend to get up to date.

- **Revision** - We coordinate the delivery of revision for Y11 and the after-school revision programme that starts after Christmas for Y11 students. We also have the "How to Revise" website, the first stop for all of your revision tips and advice, which can be used by every year group.
- **After school support** - We have various staff in school who lead workshops and there are also online sessions and 1:2:1 tuition to offer further subject support within their subjects.
- **In lesson support** - We work closely with Newcastle and Northumbria university who release undergraduate students into school to support our pupils. They work with key groups of pupils in lessons and provide additional subject support after school in our hubs.
- **Enrichment opportunities** - We have organised mentoring through external providers such as NECOP to work with pupils in KS4. In addition to this we have previously run a number of successful trips including a visit to the North East Careers Fair and have had various guest speakers come into school to deliver STEM workshops and also inspirational talks from Cambridge university. While less speakers have been able to visit school, we are arranging a number of virtual opportunities for speakers to deliver sessions online in schools.
- **IT support** - if you haven't got access to a computer at home, we can help you with this. Just let the achievement team know and we can help remove this barrier to learning.

### Where can you find us?

Situated in Gibside, the achievement team is always on hand to support our pupils to be the best they can be. If you have any queries about the achievement team you can contact us in the following ways:

Email: [achievement@whickhamschool.org](mailto:achievement@whickhamschool.org)  
Tel: Mr Berry – 0191 4960026 ext. 338  
Mrs Hughes – 0191 4960026 ext. 335  
Miss Envy – 0191 4960026 ext. 318  
Miss Balmain – 0191 4960026 ext. 336  
Mrs Ross - 0191 4960026 ext. 250



**We look forward to seeing you in September! Keep working hard.**

**The Achievement Team**



# Tutor Time Activities

Our daily tutorial session is an important part of the day. It helps to ensure that pupils form a strong relationship with their tutor who helps to support them as they grow and mature. The time is used productively to ensure that pupils are settled and prepared for the day ahead. Pupils also engage in a variety of different activities which will facilitate the development of key skills and qualities. These include;

- A focus on key literacy and numeracy skills that will support their learning and raise standards across the curriculum.
- Contributing to the school community and environment through weekly circle time sessions that focus upon topical events and important issues that impact upon school.
- A weekly session that focuses on Personal, Social, Health and Citizenship Education (PSHCE) and compliments the programme delivered during curriculum time.

The Tutor Time PSHCE programme will focus upon the following topic areas across KS3 to ensure pupils are provided with a broad and balanced experience;

- the development of the political system of democratic government in the United Kingdom, including the roles of citizens, Parliament and the monarch
- the operation of Parliament, including voting and elections, and the role of political parties
- the precious liberties enjoyed by the citizens of the United Kingdom
- the nature of rules and laws and the justice system, including the role of the police and the operation of courts and tribunals
- the roles played by public institutions and voluntary groups in society, and the ways in which citizens work together to improve their communities, including opportunities to participate in school-based activities
- the functions and uses of money, the importance and practice of budgeting, and managing risk





# Whickham Equipment

As part of our continuing drive to raise standards and achievement the school planner must be utilised effectively by pupils, parents and staff as a medium for communication and also as a teaching and learning tool which will be used in the classroom and at home. In addition we expect all pupils to have an equipment pack which have a positive impact upon teaching and learning.

Basic Items pupils required	Items supplied by school
<ul style="list-style-type: none"> <li>• Compass</li> <li>• Eraser</li> <li>• Pens (1 black, 1 green)</li> <li>• Pencil</li> <li>• Pencil sharpener</li> <li>• Protractor</li> <li>• Green highlighter</li> <li>• Coloured pens or pencils</li> <li>• Whiteboard pen</li> <li>• Post it note pad</li> </ul>	<ul style="list-style-type: none"> <li>• Post it note pad</li> <li>• Index/ Flash cards</li> </ul>

## Starter Packs

When a pupil enrolls at Whickham School they are expected to purchase a starter pack. This pack supports pupils in their teaching and learning.

### Starter pack contents:

- Planner
- School tie
- Apron for DT lessons
- Equipment pack

The starter packs can be purchased through the On-line shop.



## Equipment Pack

In addition to basic equipment, the pack contains all the equipment children need to complete their work to the highest standards while also supporting active engagement in lessons. While it is of course our responsibility to supply specific assessment resources such as a post-it notes or index (flash) cards, we do need your support in ensuring your child takes responsibility in making sure their pack is always fully equipped with all the basic equipment expected within any school, this includes items such as pens and pencils. If your child's equipment pack is damaged then this also needs to be replaced with a clear pencil case.

The equipment pack is critical to ensuring children are always prepared to learn and can present their work to the highest standard, demonstrating and taking great pride in their work, just as you would expect as parents and carers.

Can we ask that you support us through taking an active role in checking your child's equipment pack over the summer holidays to make sure your child is fully equipped and ready for learning in September.

You can refer to the table (left) to ensure your child has everything they need.



# P.E. Guidelines

- Full P.E. kits should be worn at all times
- If a pupil does not have their kit they will be given some to wear
- Long hair must be tied up
- If a pupil is injured they must have a note written in their planner
- Injured pupils will still be expected to wear kit and will be given a different role



## P.E. Kit

### Compulsory Items

- School sports shirt
- School sports socks
- Plain leggings OR shorts OR tracksuit bottoms in school colours (navy blue)

### Optional Items

- School training top
- Plain black base layer
- Water bottle



## Protection

It is compulsory that pupils wear shin pads and mouth guards whilst participating in certain sports e.g. rugby, hockey, football etc.

## School Teams

It is advised that pupils who represent school teams purchase a school training top to wear for fixtures and competitions and bring a water bottle.





You can use ClassCharts to track your child's behaviour and homework as well as viewing their timetable. This daily feedback to parents replaces the annual written reports. You can also view announcements from our school.

If you have more than one child, you can access ClassCharts information about your children from a single, centralised parent account.

Class Charts for parents can be accessed through the ClassCharts website [www.classcharts.com](http://www.classcharts.com), an iOS or Android apps.

You will receive a Parent code from us and this code is used to set up your ClassCharts account.





# Term Dates

## Autumn Term

Start of Term	Half Term	Last day of Term
Wednesday 7th September 2022	Monday 24th - Friday 28th October 2022	Friday 23rd December 2022

## Spring Term

Start of Term	Half Term	Last day of Term
Tuesday 10th January 2023	Monday 20th - Friday 24th February 2023	Friday 31st March 2023

## Summer Term

Start of Term	Half Term	Last day of Term
Monday 17th April 2023	Monday 29th May - Friday 2nd June 2023	Friday 21st July 2023

## Important Dates

7th September: Year 7 first day at Whickham School

1st Oct 2022 (TBC): Y7 Meet the Tutors

9th May 2023 (TBC): Y7 Parents Evening

## Timings of the School Day

8.35..... Warning Bell  
8.40..... Tutorial  
9.00..... Movement time  
9.05..... Period 1  
10.05..... Movement time  
10.10..... Period 2  
11.10..... Break

11.25..... Period 3  
12.25..... Lunch  
13.10..... Period 4  
14.10..... Movement time  
14.15..... Period 5  
15.15..... End of School Day  
**Every second Tuesday school will finish at 2.10pm**





G1, G2, G3, G4 Geography  
 G5, G6, G7, G8, G11 History  
 G9, G10, G12 Religious Studies  
 G13, G14 Music

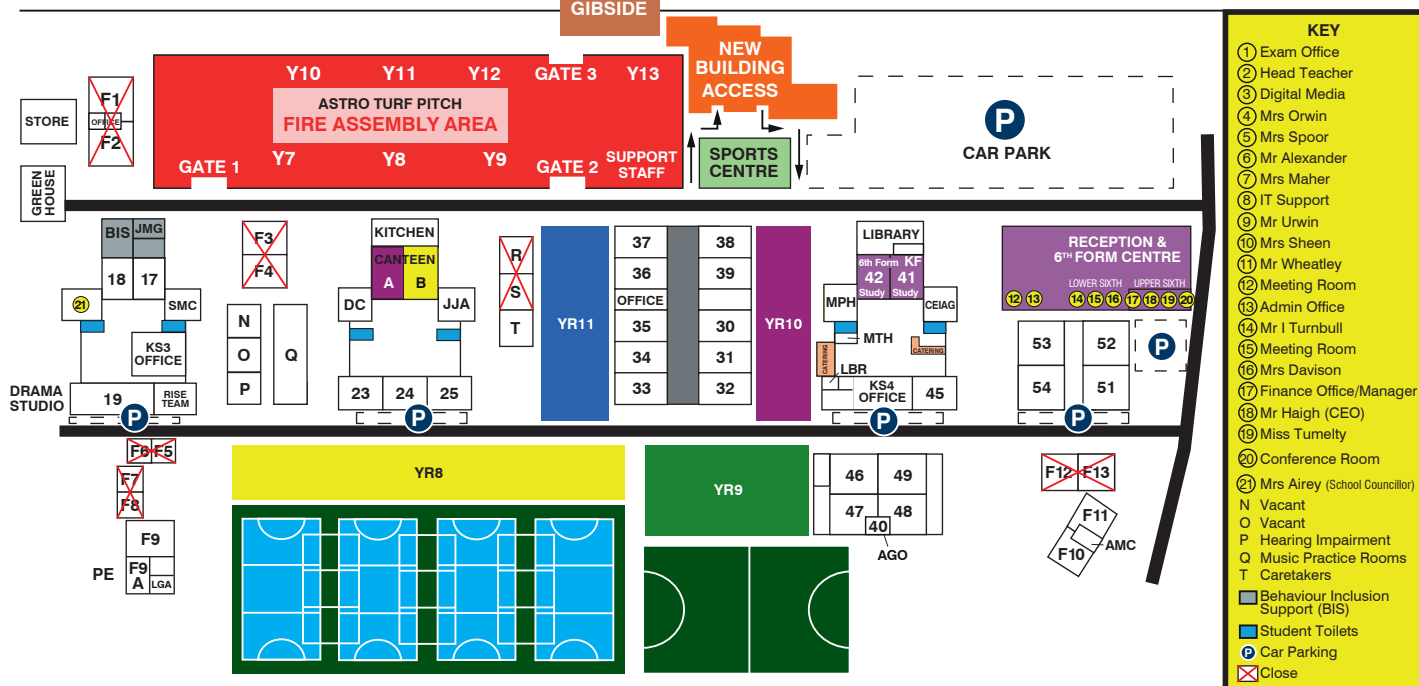
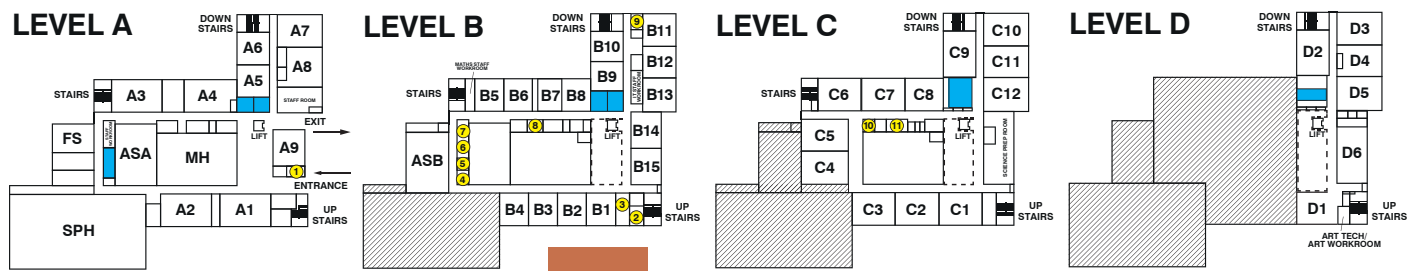
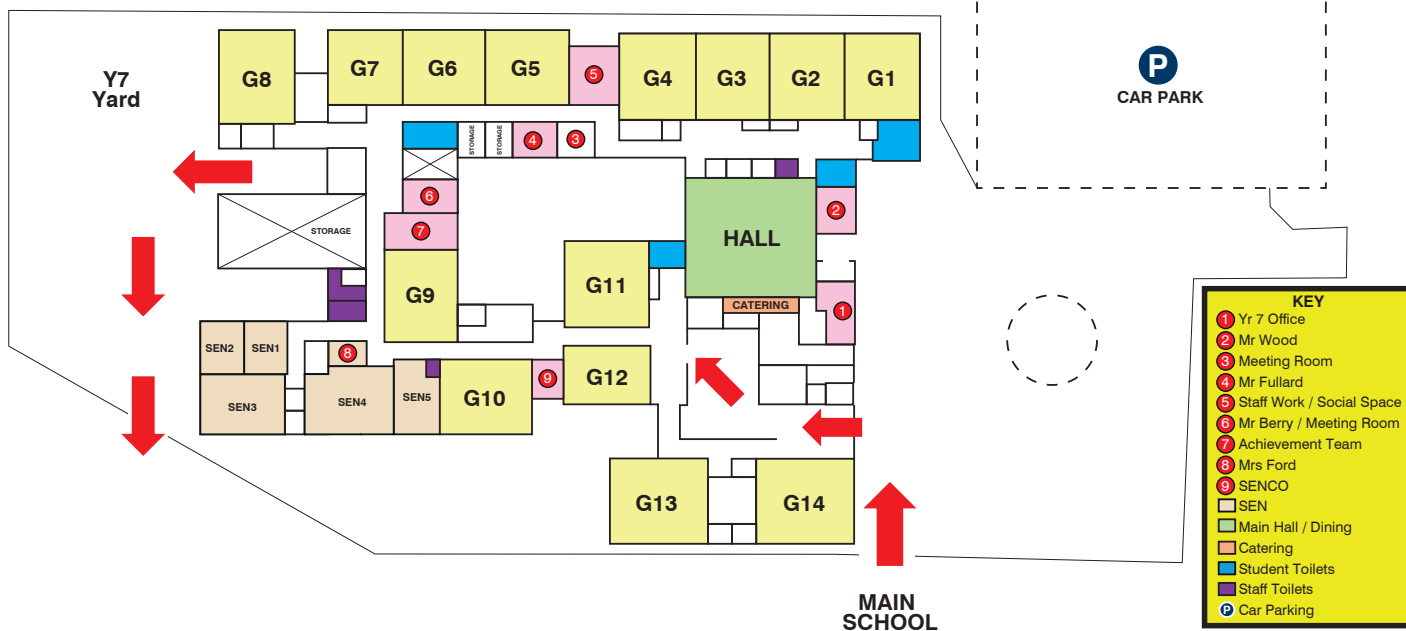



# WHICKHAM SCHOOL

Burnthouse Lane  
Whickham  
Newcastle upon Tyne  
NE16 5AR  
T: 0191 4960026  
[www.whickhamschool.org](http://www.whickhamschool.org)