



**SIMON BALLE  
ALL-THROUGH SCHOOL**  
Creating tomorrow's citizens today

Have your say – proposed new sports hall consultation



# OVERVIEW OF THE PROPOSALS



Simon Balle All-through School is an 'Outstanding' all-through school, providing excellent primary and secondary teaching facilities to our students aged 4-18. Our site comprises an original set of school buildings, which were completed in 1957 and a new sustainable block for primary teaching.

A recent capacity survey has identified an acute need for additional indoor sporting facilities to be developed to accommodate the delivery of curriculum and extracurricular activities.

The aim of this project is to adopt sustainable design and development methodologies to reduce energy usage and carbon emissions and to deliver much needed facilities. The project will take into account the historical context of the site and surrounding areas to ensure the proposal is sensitive and responsive.

This project also creates an opportunity to address the constraints of the site to provide a considered development and an outline masterplan for future works. Positioning focal buildings and elements on key routes could improve legibility and wayfinding throughout the site. In addition, well used footpaths could be formalised to create a clear site axis. These focal buildings can address sightlines into the site and enhance sightlines.



# THE NEED FOR A NEW SPORTS HALL

This proposal has been developed to address basic need at Simon Balle, an Ofsted 'Outstanding' school without a Sport England and BB103 compliant sports hall. At present, all home fixtures are hosted by a secondary school in Ware as the current 1950's hall is not suitable for competitive fixtures.

To address this need, the proposal includes a new sports hall with associated storage and changing facilities. The sports hall will be sized and finished to Sport England requirements for a four court badminton hall so that high level competition can be hosted on site.

The sports hall will be available for community use and is within close proximity to Hertford Cricket Club making it an ideal venue for indoor cricket. The sports hall will provide modern, quality facilities for the benefit of the public for a range of sports including badminton, cricket, football, netball and table tennis.

The sports hall will also include a new reception and administration area which is welcoming and well positioned to monitor access to and from the school site, assisting the school in ensuring the safeguarding of the children and young people in our care.

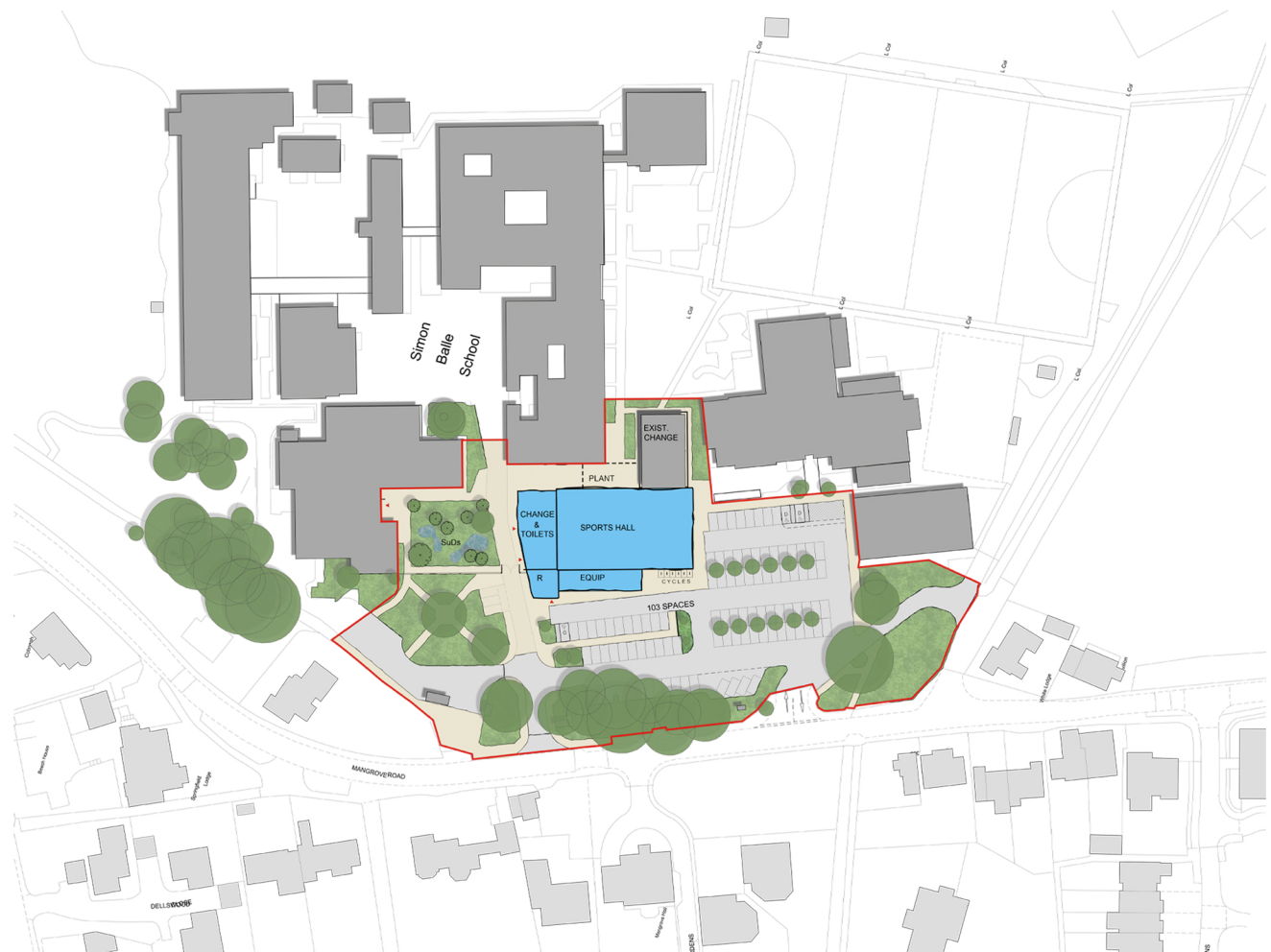

Proposed site plan



# EMERGING DESIGN PROPOSALS

The proposed design looks to utilise sustainably sourced materials to achieve a light and open internal aesthetic. Through considered elevational design, the internal areas will benefit from natural daylighting and ventilation to reduce the amount of mechanical plant equipment required.

The massing of the proposed building responds directly to existing buildings on site and the need for improvements in site wayfinding.

A pedestrian central entrance spine will enhance the visual connection to the schools main entrance and its immediate context and in addition creates a planted screen to the car park. Surfaces should be tactile and durable, with clear wayfinding strategies incorporated early in the design stages so that users feel well orientated.

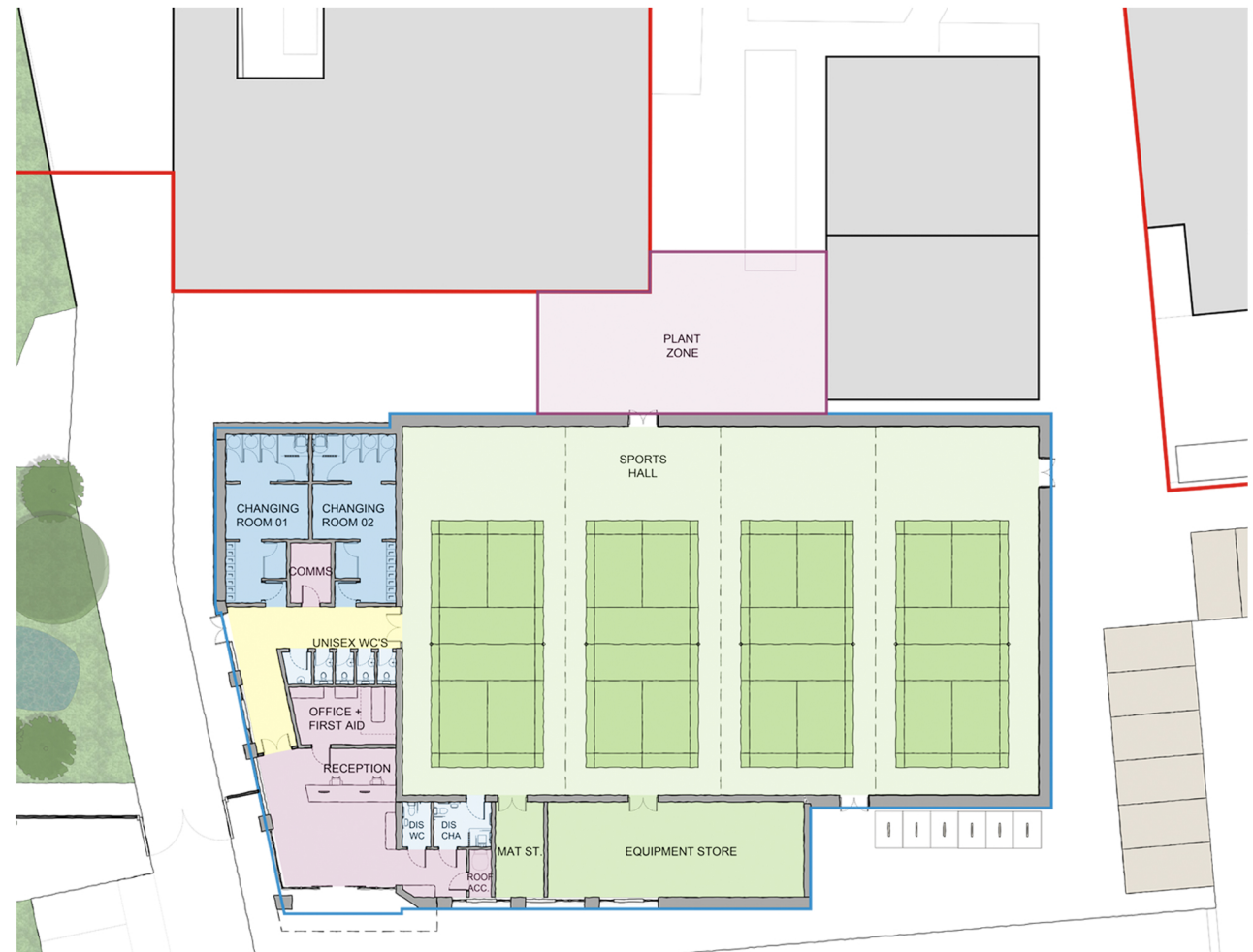

Proposed floor plan





# EMERGING DESIGN PROPOSALS (CONTINUED)

It is recommended that sustainable low carbon site materials are used where possible for the upgraded landscaping. Materials should be sourced from the UK with as much recycled material as possible. Timber should be sustainably sourced (FSC).

A number of sustainable cladding options could be utilised on the proposed building. These will be reviewed in terms of suitability, availability, life expectancy, weathering, embodied carbon and special characteristics.

Coloured panels could be introduced; these could be uniform and reflect the school colours. They should be constructed using a board made from FSC certified wood sources, which can be coated in any colour. The boards are resistant to rot and decay and are consistent in quality and thickness.

External landscaped areas could potentially utilise the on site cut soil to form land features to create a mix of landscaped social areas such as seating features to promote student interaction and promote well-being. Potential seating edges and decking should be sustainably sourced whilst durability and longevity will be considered. Gabions could be built with recycled stone to create the opportunity for biodiverse habitat creation.

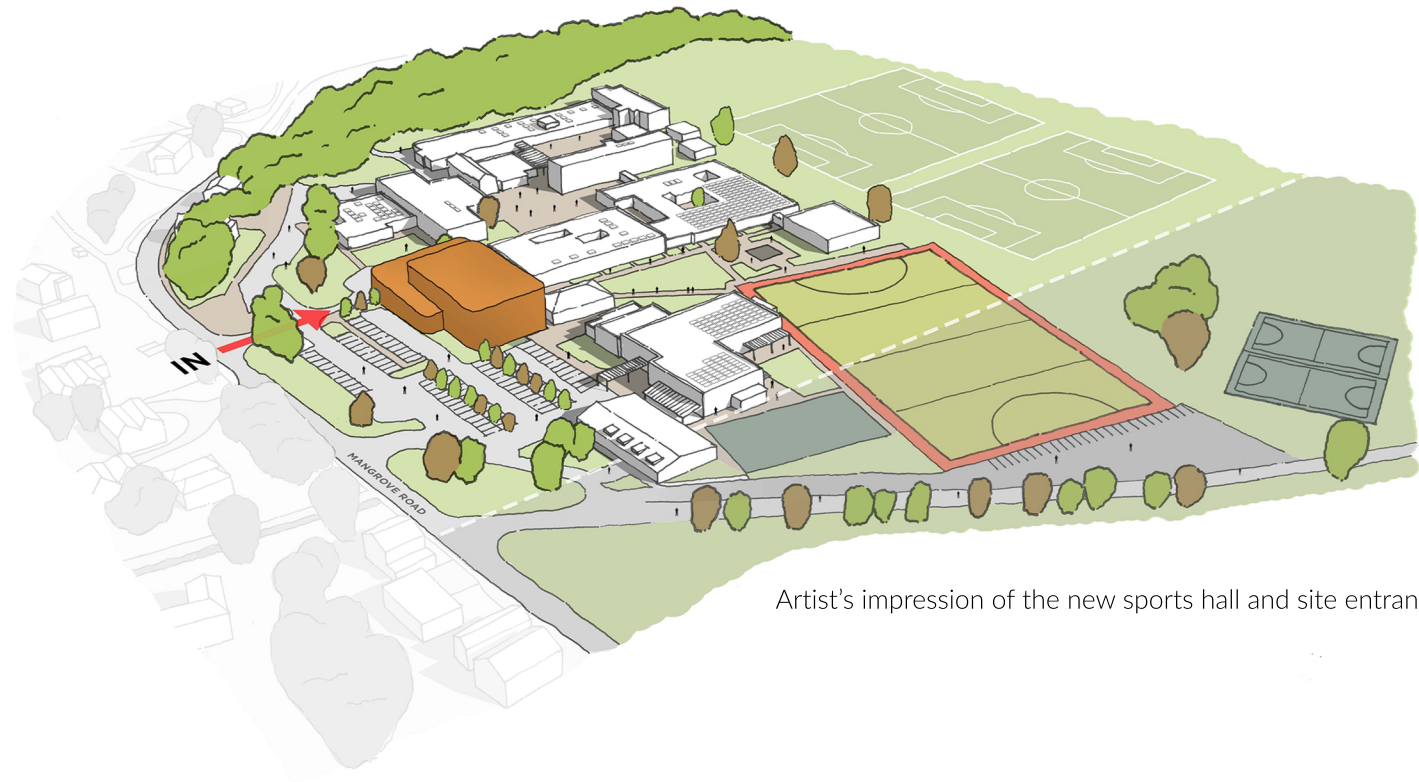

Artist's impression of the new sports hall and site entrance









# PUBLIC CONSULTATION

We are excited about our proposals and hope you will be able to join us to discuss our plans.

We will be holding a public consultation event on **Thursday 13th October from 3.30pm to 8:00pm** in the secondary school library and would like to invite you to attend to speak to the school and design team and share your thoughts.



Shaping  
our  
community



Shaped by  
our  
community



Alternatively, you can visit our consultation webpage and leave your feedback via our online questionnaire at [www.simonballe.herts.sch.uk/community/public-consultation/](http://www.simonballe.herts.sch.uk/community/public-consultation/)

Comments must be received by 31 October 2022.

We will take account of your comments when finalising the planning application. There will be another opportunity to make comments directly to East Herts District Council on the application in due course.

