



Robinwood

Maes-y-Nant, Cross Lanes, Wrexham

9th March – 11th March 2026



robin  wood
Activity Centres



- Departure from Year 6 classrooms on **Monday 9th March**.
- Return **Wednesday 11th March** at approximately 3pm, depending on traffic.
- Cost per child this year will be **£303**.
- Please confirm attendance plus the payment of a non-refundable deposit by **Wednesday 17th December**.
- The payments can be made to suit you. Information of a payment plan is available today. However, please can this be paid in full by **2nd March 2026**.

Activities

- There are 15 possible activities in total with a variety of programmes depending on the time of year e.g.:
- Piranha Pool
- Zip Wire
- Giant Swing
- Archery
- Team Challenge etc.



Typical 3 Day Programme

Around 24 hours of high-quality activity sessions packed into a 3 day course. We ensure your group gains the most possible from every moment spent at Robinwood.

Day One

- Arrivals are typically about 11.00am
- Lunch
- Giant Swing
- Raft Building
- Crate Challenge
- Evening Meal
- Trapeze
- Quest
- Hot Chocolate and Review

Day Two

- Breakfast
- Zip Wire
- Canoeing
- Archery
- Lunch
- Nightline
- Piranha Pool
- Caving
- Evening Meal
- Team Challenge
- Hot Chocolate and Review

Day Three

- Breakfast
- Dungeon
- Climbing
- Challenge Course
- Lunch
- Departures are typically about 1.30pm



The right balance of activities

We are conscious of the importance of providing the right balance within the activity programme including a range of adventure activities, themed problem solving sessions, watersports sessions, activities that will challenge, activities that will develop teamwork, activities that will stimulate the imagination and activities that present fantastic learning opportunities in a way that goes beyond what can be offered in a classroom environment.

Developing children at Robinwood

Throughout their time at Robinwood, children:

- Challenge themselves to overcome fears
- Improve their listening skills
- Take on leadership roles
- Become more confident speaking out in a group
- Support others in challenging situations
- Become great team members and help their group work more as a team
- Work successfully with children they would not normally work with
- Become more aware of the needs of others
- Improve their problem-solving skills
- Develop new skills



Supervision and Safety

- Staff ratio of at least 1:10 (staff will be confirmed nearer the time).
- Children will not find out their group leader, group members or their dorm until we are about 10 minutes away from Robinwood.
- Highly trained and qualified staff lead and supervise the children throughout all activities; school staff will also be present.
- Outside of activities, Robinwood and Norris Bank staff are timetabled to supervise at all times, including meals.
- Evening and night supervision is rigorous with staff on duty in corridors at all times and Mrs Doe, Miss Aspey and Mrs Furmidge are on call as well.

Accommodation

- Children sleep in dormitories with bunk beds and rooms that sleep from 4 to 14 children.
- The dormitories will only be for our school as will all activity groups and meals.
- The showers are timetabled after each wet and muddy activity and have separate cubicles to ensure privacy.



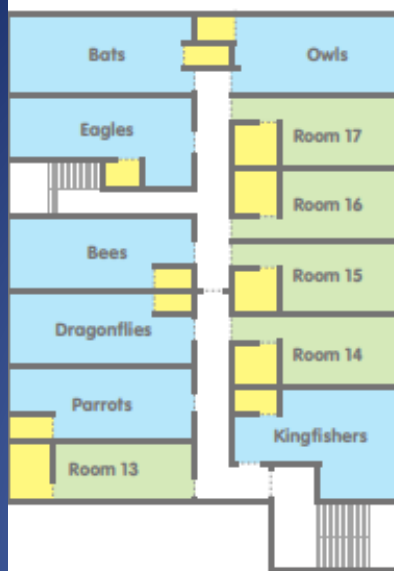

- Children's Rooms
- Teachers' Rooms/Area
- Toilets/Shower Area
- Dining Rooms
- Session Areas



Food!

- A cooked breakfast and evening meal everyday!
- Breakfast: cereals, toast, sausage, bacon, waffles etc.
- Lunch: sandwiches, wraps, pizza, burgers, sausage roll, fruit, juice, water, crisps, biscuits etc.
- Evening Meal: pizza, chicken curry, jacket potato, pasta, fish and chips ice cream etc.
- Dietary requirements can easily be catered for. Please let your class teacher know about this as soon as possible.

Maes y Nant Menu

Day One

Break time snacks are provided and additional fruit is always available.

There is always a vegetarian option and we regularly cater for special diets such as coeliac disease (gluten free), lactose free, dairy free and halal.

Please let us know in advance of any dietary needs.

Lunch

Cheese and Tomato Pizza
Salad
Crisps
Biscuit
Orange Slices
Carrot & Cucumber Sticks

Snacks

Biscuit

Evening Meal

Baked Potato (with choice of fillings)
Pasta Bolognese
Tomato Pasta
Garlic Bread
Salad
Ice Cream

Hot Chocolate and a biscuit in the evening.

Day Two

Breakfast

Sausage
Mini potato waffles
Beans
Toast
Choice of Cereals
Fruit

Lunch

Chicken Burger
Jumbo Hot Dog
Sandwich (cheese, ham, tuna or jam)
Muffin
Orange Slices
Carrot & Cucumber Sticks

Snacks

Choc Biscuit

Evening Meal

Fish Fingers and Chips
Curry and Rice
Naan Bread
Peas and Sweetcorn
Cookie

Hot Chocolate and a biscuit in the evening.

Day Three

Breakfast

Sausage
Mini potato waffles
Beans
Toast
Choice of Cereals
Fruit

Lunch

Sausage Roll
Cheese & Onion Pasty
Salad
Crisps
Orange Slices
Carrot & Cucumber Sticks
Biscuit

This is an example of a previous menu.

This is not a set menu from the centre.

Menu will be known on the days we are at Robinwood.

Children's Code of Conduct

Follow instructions given:

It is vital for everyone's safety, and for the maximum enjoyment of all the activities, that everyone listens carefully to instructions given and follows those instructions.

Keep yourself and everyone else safe:

Throughout your stay make sure you behave in a way that keeps yourself, and everyone else, safe. Following instructions is important. But you will also need to behave sensibly throughout your stay.

Challenge yourself:

Please come to Robinwood ready to have a go at all the activities, to challenge yourself and achieve as much as you can.

Be a good team member:

A good team member will always listen to others in the group, as well as putting forward their own ideas. They will be keen to help and encourage others, whilst setting a good example by taking full part in all activities themselves.

Take responsibility for your own property and jobs:

Look after your own clothing and any other items that you bring with you. Help pack your bag so you know exactly what you have brought with you.

Keep your dormitory clean and tidy

At meal times, follow the instructions of Robinwood staff, to make sure that after your meal any rubbish is put in the bin provided.

Be helpful to others:

Offer encouragement and support to others.

Listen carefully to other people's ideas and encouraging them, as well as putting forward your own ideas.

Help your group complete all the jobs that need to be done during your time at Robinwood.

Respect other people's privacy and property:

Respect the property of Robinwood Activity Centre. Also respect other people's property. Never enter anyone else's dormitory or look in anyone else's bag at. In your own dormitory, you should not go onto anyone else's bed.

Be a good ambassador for your school:

At Robinwood you will be a representative or ambassador for your school. It is important that you respect the rights, dignity and worth of all children attending Robinwood regardless of age, gender, ability, race, cultural background, religious beliefs or sexual identity. Good behaviour is not only important during the day, it is also important at bedtime and overnight.

Clothing etc.

- As the children may get wet or muddy, a drying room is offered.
- **No** mobile phones or cameras.
- Dress appropriately to start an outside activity when we arrive.
- **No** aerosols; it sets the smoke alarms off.

Items Needed

- 3 T-shirts
- 3 Sweatshirts/Fleeces/Hoodies
- 3 Pairs of trousers
- 1 pair of shorts (knee length - these will be worn in water)
- 6 sets of underwear
- 6 pairs of socks
- 1 Pair of trainers
- 1 Pair of outdoor shoes/boots
- 2 Towels
- 1 Coat (waterproof if possible)
- 1 Warm hat/ sun hat
- 1 Pair of gloves
- 1 Set of nightwear
- 1 Bag of toiletries
- 1 Black bin liner (for wet/muddy clothes)
- No snacks
- Book for reading at bedtime
- Small teddy

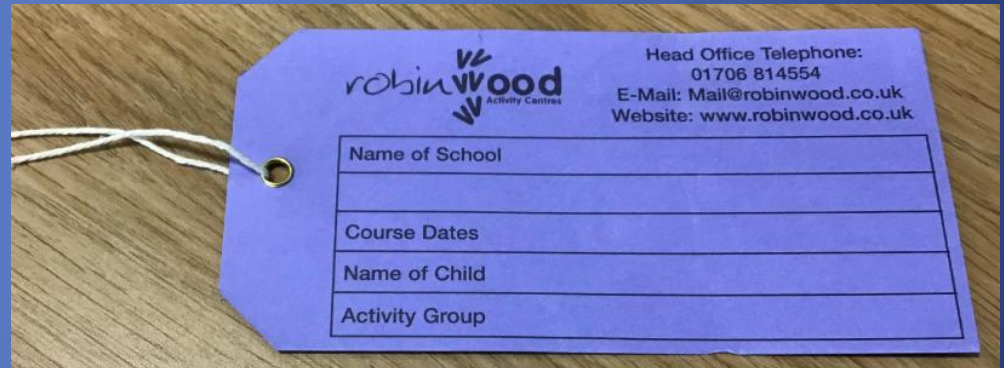

robinwood
Activity Centres

Head Office Telephone:
01706 814554
E-Mail: Mail@robinwood.co.uk
Website: www.robinwood.co.uk

Name of School
Course Dates
Name of Child
Activity Group

All these information
alongside a luggage label
will be sent nearer the
time.

Essential Form

In January you will receive

- Personal information form (contact number, first aid, allergies, medical details/consent, dietary requirements)

Please return by **Monday 12th January**

Medicines

- Form from information pack must be completed in advance/prior to us leaving.
- Dosage in separate envelopes with date and time on.
- Travel sickness tablets in envelope with time to be given on for return journey.
- Inhalers - each child will carry one at all times and their group leader will carry their school inhaler.
- By **Wednesday 4th March** please unless...

On the Day

- Bring any medicines that have been prescribed over the weekend or which you were unable to bring into school earlier.
- Brown inhalers where appropriate.
- Wear clothes suitable for outside activities.
- Drop your child off at the hall with their bag. Children will register in class before returning to collect their bag.



Robinwood

Maes-y-Nant, Cross Lanes, Wrexham

9th March – 11th March 2026



robinvvvood
Activity Centres