

Notes

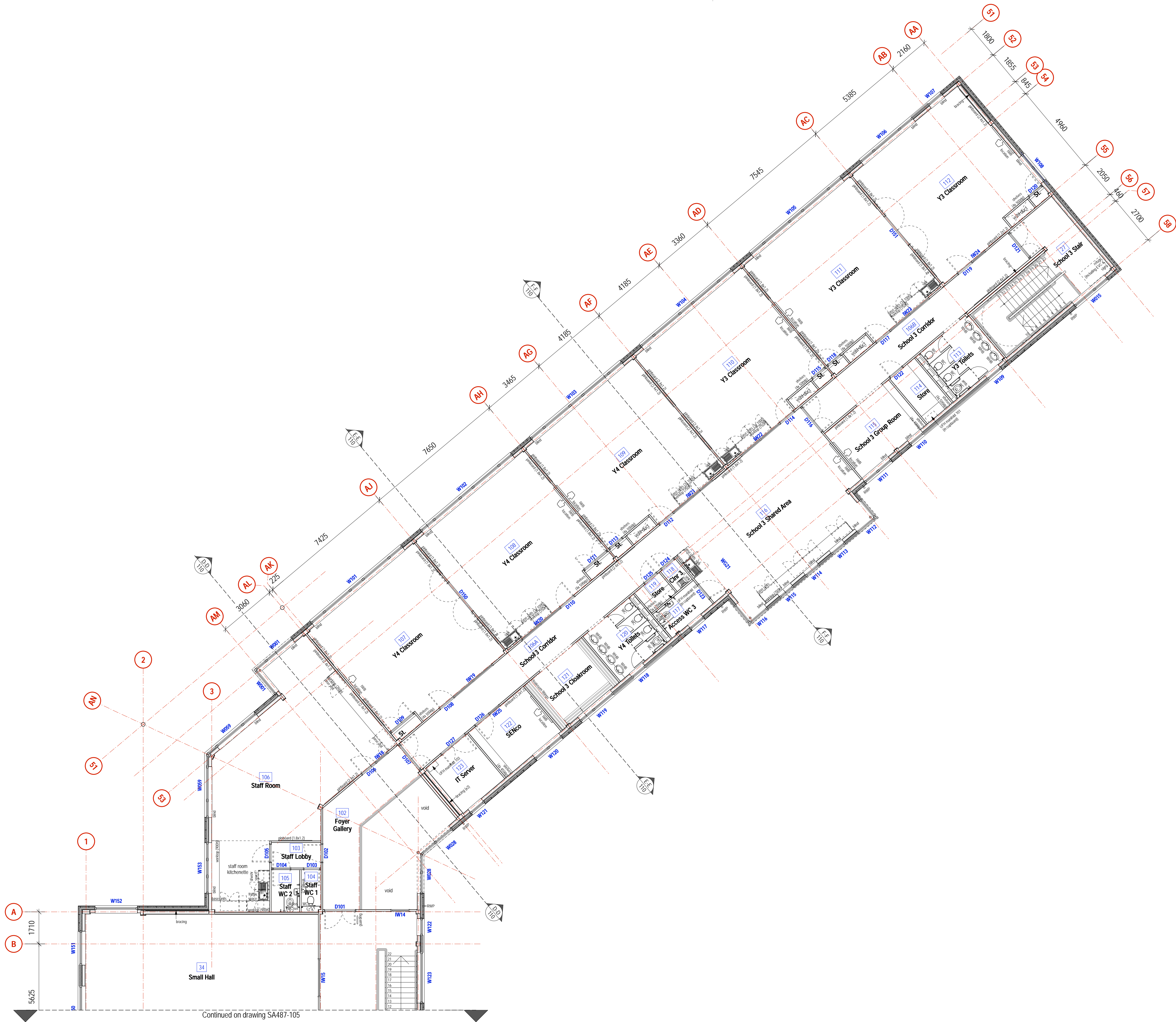

Continued on drawing SA487-105

A	01/05/14	Door & window etc references added, further fittings information shown, GLI moved & columns updated, steelwork updated generally, DO26A added	RGJ	RGJ
Rev.	Date	Description	By	Appr.





Synergy Architects Ltd
8 Euston Place Leamington Spa
Warwickshire CV32 4LN
T: 01926 450391
F: 01926 889086
www.synergyarchitects.co.uk



Willmott Dixon Construction Ltd
Charity House
High Street
Coxwold
Birmingham
B46 3BP

Brooklands Primary School 2 & Community Facility Milton Keynes			
Drawing			
School Building General Arrangement Plan First Floor - Sheet 2			
Scale	Date	By	Approved
1:100 @ A1	10/04/2014	RGJ	RGJ
No. To	Drawing No.	Revision	
SA487	106	A	
Copyright Synergy Architects Ltd. This drawing, or any of its contents, may not be copied, reproduced or distributed without the written consent of Synergy. Figured dimensions only to be taken from this drawing - do not scale. All contractors, subcontractors and/or specialists are responsible for taking and checking all dimensions relating to their work on site.			